

CLOSE BOARD FENCE - ELEVATION

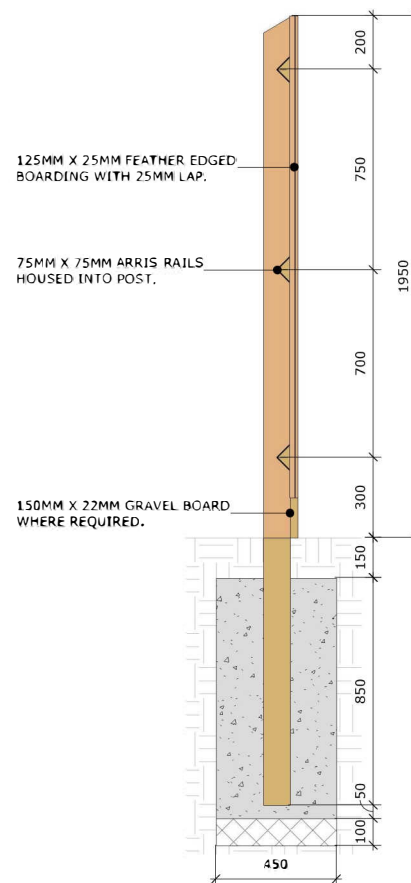

SECTION

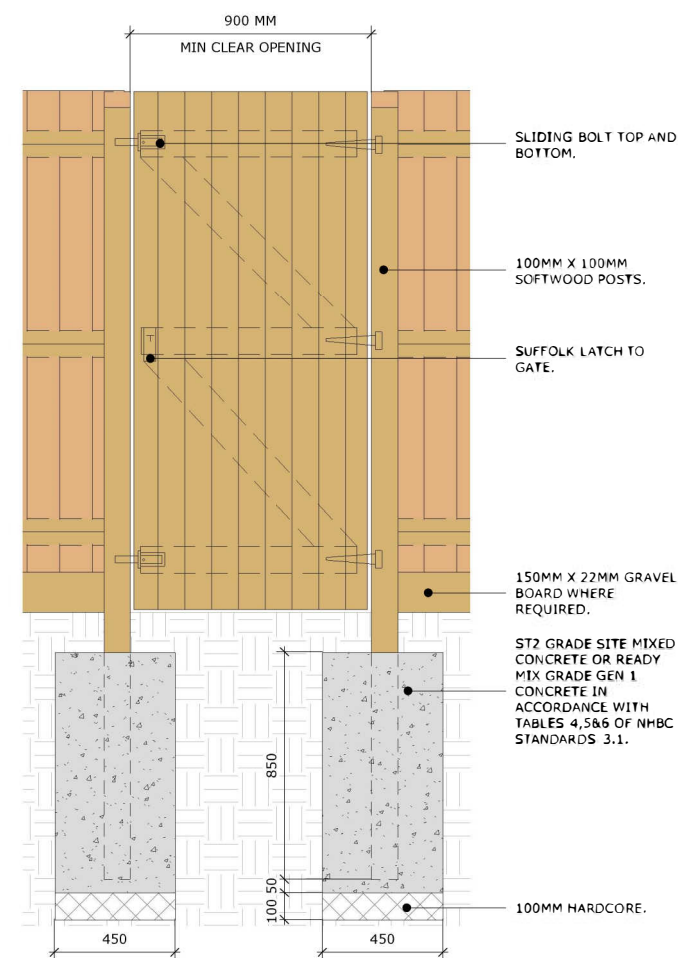

GATE ELEVATION

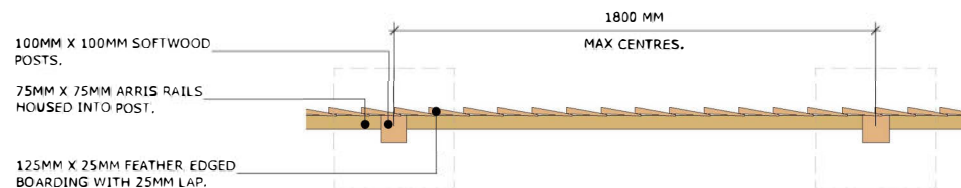

PLAN

NOTES:

- ALL TIMBER TO BE FSC AND IMPREGNATED WITH AN APPROVED PRESERVATIVE.
- BUSINESS UNIT TO ASSESS SUITABILITY OF DETAIL FOR INDIVIDUAL DEVELOPMENTS AND CONSULT WITH STRUCTURAL ENGINEER ACCORDINGLY.
- TO BE READ IN CONJUNCTION WITH BS1722 PART 5.

category

EXTERNAL WORKS DETAILS

description

EXTERNAL WORKS - CLOSE BOARDED FENCE (1800MM)
Incl. heights of 1800mm & 1950mm

scale

1 : 20

revision

00

project

GROUP - VIS - S - EX - D2 - A - FC - 0213

originator

volume

level

type

role

class

number

Vistry Group

STANDARD DETAIL

SUBJECT TO NHBC
APPROVAL