

C:\Users\williammcaney\Motion\Staff\Site - Fw115 2507082\Drawings\2507082-04E & 05D.dwg

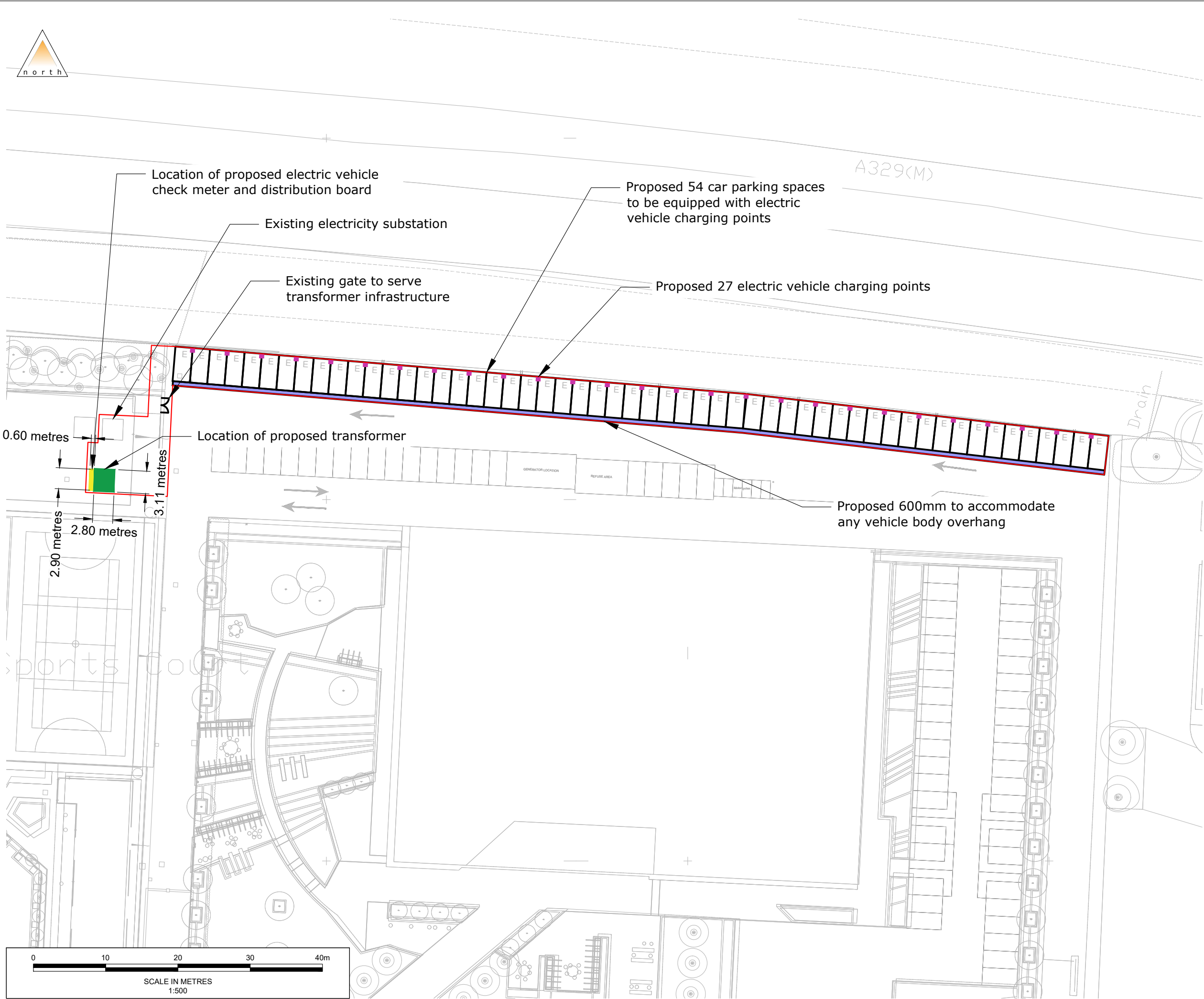

Notes

1. All levels and dimensions to be checked on site before any work commences. All dimensions in metres unless stated otherwise.
2. This drawing is based on topographical survey information and Motion cannot guarantee the accuracy of the data provided.
3. This drawing is based on OS mapping and Motion cannot guarantee the accuracy of the data.
4. Proposed transformer dimensions have been determined with reference to drawing TR18 SSE prepared by Envico Engineering Ltd.

Legend

- Site Location
- Proposed EV Charging Parking Space
- Proposed EV Charging Points
- Proposed Transformer
- Proposes Electric Vehicle Check Meter and Distribution Board
- Proposed 600mm Buffer

E	Updated Arrangements	WMC	PdeJ	PdeJ	09/12/2025
D	Updated Arrangements	WMC	PdeJ	PdeJ	09/12/2025
C	Updated Arrangements	WMC	PdeJ	PdeJ	30/09/2025
B	Updated Arrangements	WMC	PdeJ	PdeJ	05/09/2025
A	Updated Arrangements	WMC	PdeJ	PdeJ	05/09/2025
-	First Issue	WMC	PdeJ	PdeJ	03/09/2025
Rev.	Description	Drm	Chk	App	Date

Drawing Status:

FOR PLANNING
NOT FOR CONSTRUCTION

motion

Guildford - Reading - London
www.motion.co.uk

Client:

Winnersh Midco S.A.R.L

Project:

Winnersh Triangle 1180 EV Chargers

Title:

Proposed Parking Arrangements

Scale: 1:500 (@ A3)

Drawing:

2507082-04

Revision:

E