

PLANT SCHEDULE					
NATIVE HEDGEROW - Planted at 6 per lin.m and protected with spiral bound shrub guards					
Abb	Species	Size	Height (cm)	% in Mix	Number
Ca	Corylus avellana	BR	60-80	20%	197
Cm	Crataegus monogyna	BR	60-80	50%	492
Ia	Ilex aquifolium	BR	60-80	5%	49
Psp	Prunus spinosa	BR	60-80	10%	98
Rc	Rosa canina	BR	60-80	5%	49
Vo	Viburnum opulus	BR	60-80	10%	98

NATIVE TREE PLANTING (STANDARD)					
Abb	Species	Size (cm)	Height (cm)	Root	Number
Pp	Prunus padus	12-14	350-400	R8	3
Sa	Sorbus aucuparia	12-14	350-400	R8	3

NATIVE SHRUB MIX - Planted at 1 per sq.m and to be protected with spiral bound shrub guards					
Abb	Species	Size	Height (cm)	% in Mix	Number
Ca	Corylus avellana	BR	60-80	20%	44
Cs	Cornus sanguinea	BR	60-80	10%	22
Cmo	Crataegus monogyna	BR	60-80	30%	66
Ia	Ilex aquifolium	2LC	40-60	5%	11
Msy	Malus sylvestris	BR	60-80	5%	11
Rc	Rosa canina	BR	60-80	10%	22
Sn	Sambucus nigra	BR	60-80	10%	22
Vo	Viburnum opulus	BR	60-80	10%	22

- PLANTING NOTES:
- Plant handling at the nursery, and during transit up to delivery, shall be in accordance with 'Plant Handling', the booklet published by the Committee for Plant Supply and Establishment (CPSE). The contractor shall comply with clauses 3 & 4 of the above booklet (obtained from the Horticulture Trades Association, 19 High Street, Theale, Reading, Berks RG7 5H) which refers to the receipt, unloading and temporary storage of plants.
  - Plants shall be first class examples of their species or variety, free from all pests and diseases, with good fibrous root systems and materially undamaged (refer to relevant sections of BS3936 Parts 1-4 'Specification of Nursery Stock').
  - All planting is to be in general compliance with BS4428: 1989 'Code of Practice for general landscape operations'
  - Tree Planting:  
One number 80 litre bag of compost (non-peat based) should be roughly incorporated between two tree pits and a slow release tree fertiliser (in line with manufacturers recommendations) should also be incorporated into the mix. The compost and fertiliser must be thoroughly mixed with the excavated material prior to back filling the tree pit. Any large stones and rubble should be removed if excavated during these works and the base of the pit should be broken out to ensure that it is free draining. Trees should be secured with double timber stake, timber cross bar and rubber tree tie. As a guide, trees should be planted in tree pits of the following minimum sizes:  

i) 12-14cm girth	800 x 800 x 600mm deep
------------------	------------------------
  - All BR Whips and BR stock (proposed native understory mix and single species hedgerow) to be protected with a spiral-bound tree/shrub guard and secured into place with a cane. Ensure that areas around the base of shrubs are maintained weed free during the establishment period using a glyphosate based herbicide. BR stock should be notch planted and heeled in securely to firm into position.
  - Shrub Beds and Planting General:  

i) All beds should be free draining and free from builders rubble and large stones. There should be min 300mm of good quality top soil to all the shrub beds.
ii) Areas to be treated with a non-residual glyphosate based herbicide prior to planting and cultivated to a depth of 150mm.
iii) A slow release fertiliser mixed with a peat free compost should be incorporate into the back fill material when planting the shrubs to give them the best possible chance of establishment.
iv) For hedges dig a trench the full length of the hedge 500mm wide x 300mm deep and break up the base to facilitate drainage.
  - When storing the topsoil, compaction and contamination should be prevented by covering and not allowing construction plants to pass over it. It should also be handled in the driest conditions possible and not after a heavy rainfall. When spreading the topsoil do not firm, consolidate or compact it.
  - Finishing Beds:  

i) The finished surface of the bed should be free from weeds, stones or rubble and the surface of the soil cultivated to level out any clumps, mounds or depressions.
ii) When planted all hedge and shrub areas to be mulched with 50mm depth of small grade bark mulch.
iii) The beds should be maintained weed free and the beds topped up annually with bark mulch as required.
  - Grass:  

i) Beds should be free draining and free from rubble and large stones. There should be min 150mm of good quality top soil to all the areas to be sowed.
ii) Areas to be cultivated to a depth of 150mm and finished to a fine tilth with smooth even contours and gradients.
iii) Prior to laying turf the areas should be sprayed with a non-residual glyphosate based herbicide.
iv) Ensure that the grass is maintained to 50-75mm and once established mown up to 12 times a year in the growing season.
  - Germinal 'WFG20 Eco Species Rich Lawn' mix:  

i) To be mowed whilst still allowing lower growing species to establish.
--
  - Watering:  

i) All Trees and Hedges to be watered in the first year of establishment regularly during periods of drought until established.
ii) For the trees in the first year of establishment and in subsequent years if there is a drought. Water with the following volumes once every 2-4 weeks regardless of rainfall:  12-14cm girth trees - 100 litres minimum per month
  - Weeding:  
All shrub beds to be maintained weed free by regularly hand weeding the beds and spot treating any prolific weeds with a glyphosate based weed killer. Maintaining the bark mulch will also help to reduce weed growth.
  - The contractor must ascertain himself/herself of the exact location of underground services prior to carrying out any digging on site.

WFG20 Eco Species Rich Lawn (10g/m2)	
Mixture Breakdown	
2.0%	Wild Carrot ( <i>Daucus carota</i> )
0.5%	Common Knapweed ( <i>Centaurea nigra</i> )
0.4%	Self Heal ( <i>Prunella vulgaris</i> )
2.0%	Red Clover ( <i>Trifolium pratense</i> )
2.0%	White Clover ( <i>Trifolium repens</i> )
1.0%	Ribwort Plantain ( <i>Plantago lanceolata</i> )
2.0%	Dandelion ( <i>Taraxacum officinale</i> )
1.0%	Birdsfoot Trefoil ( <i>Lotus corniculatus</i> )
1.0%	Black Medick ( <i>Medicago lupulina</i> )
1.8%	Flax ( <i>Linum usitatissimum</i> )
0.1%	Common Mouse-Ear ( <i>Cerastium fontanum</i> )
0.1%	Cowslip ( <i>Primula veris</i> )
0.2%	Burnett Saxifrage ( <i>Pimpinella saxifrage</i> )
1.0%	Lady's Bedstraw ( <i>Galium verum</i> )
1.0%	Yellow Rattle ( <i>Rhinanthus minor</i> )
1.5%	Yarrow ( <i>Achillea millefolium</i> )
0.1%	Wild Pansy ( <i>Viola tricolor</i> )
2.0%	Common Sorrel ( <i>Rumex acetosa</i> )
20.0%	Sheeps Fescue ( <i>Festuca ovina</i> )
15.0%	Strong Creeping Red Fescue ( <i>Festuca rubra rubra</i> )
12.5%	Slender Creeping Red Fescue ( <i>Festuca rubra litoralis</i> )
12.5%	Chewings Fescue ( <i>Festuca rubra commutata</i> )
10.0%	Smooth Stalked Meadow Grass ( <i>Poa pratensis</i> )
5.0%	Browtop Bent ( <i>Agrostis capillaris</i> )
2.5%	Creeping Bent ( <i>Agrostis stolonifera</i> )
2.5%	Lolium perenne ( <i>Lolium perenne</i> )

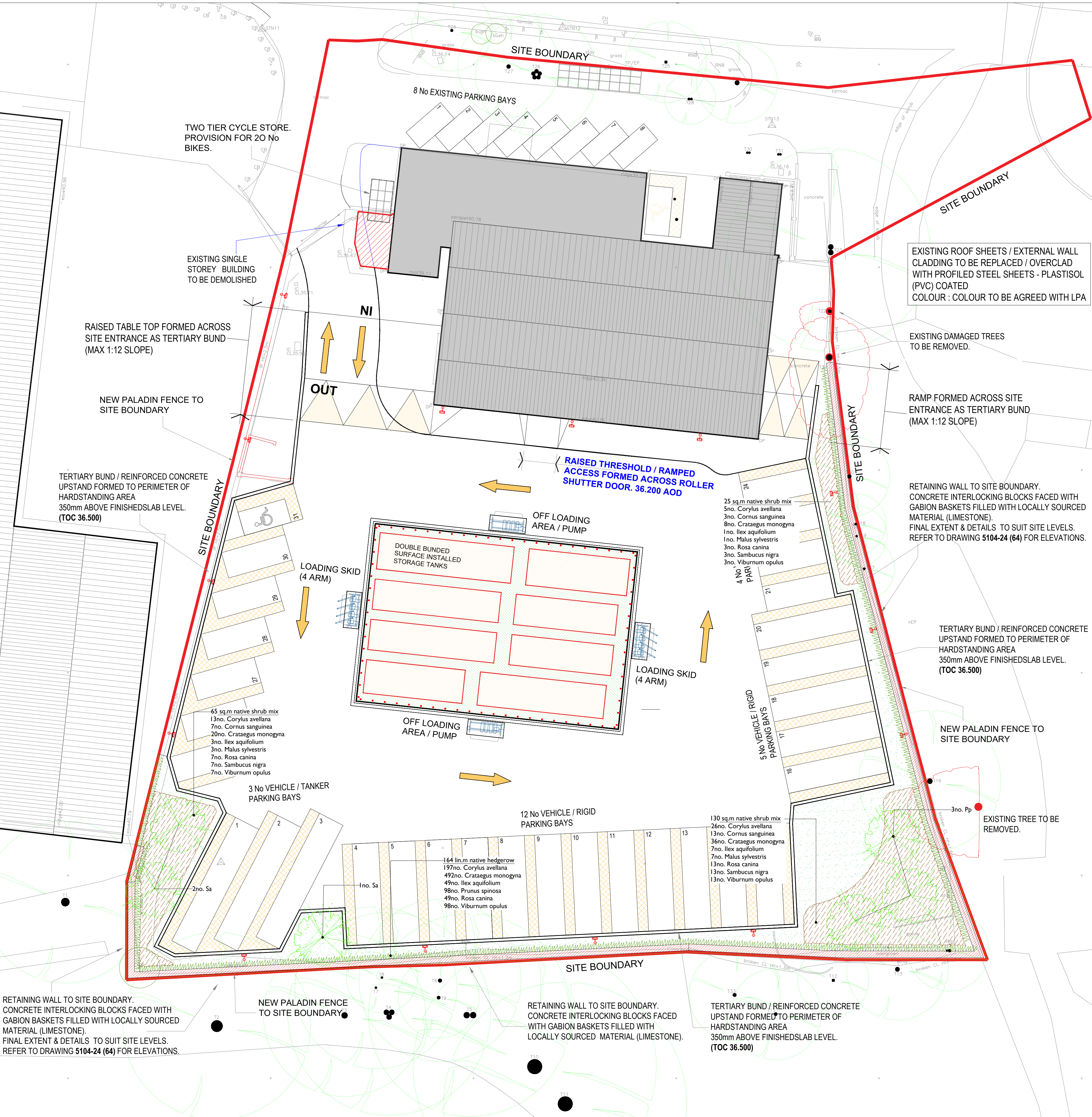

## KEY

### SOFTWORKS

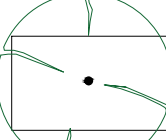

Existing trees and vegetation to be retained



**Proposed Native Trees (6no)**  
Planted as Heavy Standard 12-14cm girth trees in 600mm depth pits.

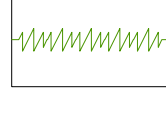

**Proposed Native Hedgerow (170lin m)**  
Planted in a staggered row at 6 per lin.m as 60-80cm whips and 40-60cm 2L pots.

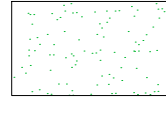

**Proposed Species Rich Grass Mix (240m²)**  
WFG20 Eco Species Rich Lawn from Germinal with a sowing rate of 10g/m2.

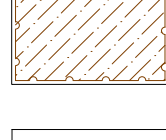

**Proposed Native Shrub Mix (265m²)**  
Planted as BR shrubs at 1 per sq.m in single species groups of 3-5no.

**NOTE: PROPOSED LIGHTING/CCTV/SERVICES CABLE ROUTES TO BE COORDINATED WITH THIS DRAWING TO AVOID CLASHES WITH TREE LOCATIONS**

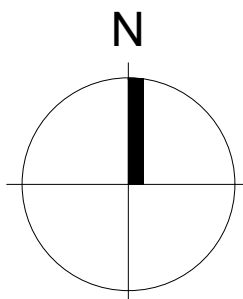

0 10 20  
SCALE - METRES - 1:200

Rev B: Boundary treatments revised TR 23/09/2025  
Rev A: Updated in response to LPA comments TR 09/07/2025



DEP LANDSCAPE ARCHITECTURE LTD

2 COMMERCIAL STREET  
MANCHESTER, M15 4RQ  
T: 0161 2419378  
E: info@dep.co.uk  
W: www.dep.co.uk

Client  
Speedy Fuels & Lubricants Ltd

Project  
Grove Oil Terminus, Charvil

Description

Planting Plan

Status

Planning

Scale

1:200@A1

Drawn

TR

Job number

5726

Drawing number

01

Date

April 25

Revision

B

Copyright DEP Landscape Architecture Ltd

All levels and dimensions to be checked on site by contractor prior to commencement. Any variations to be reported to the client. This drawing is to be read in conjunction with all others relating to the project and all information derived accordingly; any anomalies to be reported to the client. Do not scale from this drawing. Use figured dimensions only. Work shown on this drawing to be carried out in accordance with current British Standards and Codes of Practice.

© Copyright to DEP Landscape Architecture Limited. The information shown on this drawing shall not be reproduced or copied in any form without prior written consent from DEP Landscape Architecture Limited.