

CLOSE BOARD FENCE - ELEVATION

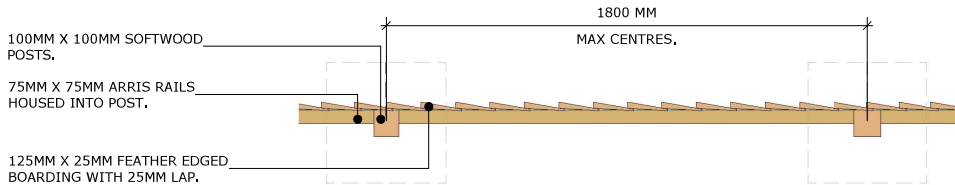

PLAN

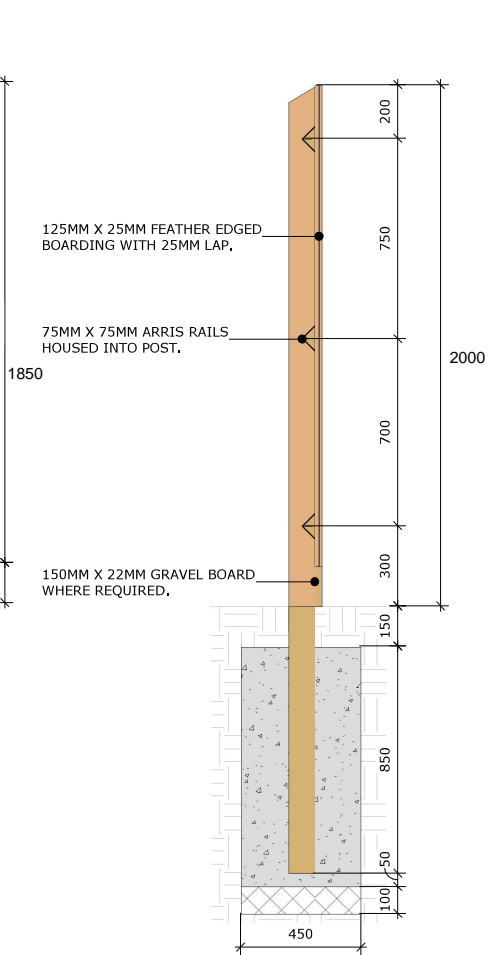

SECTION

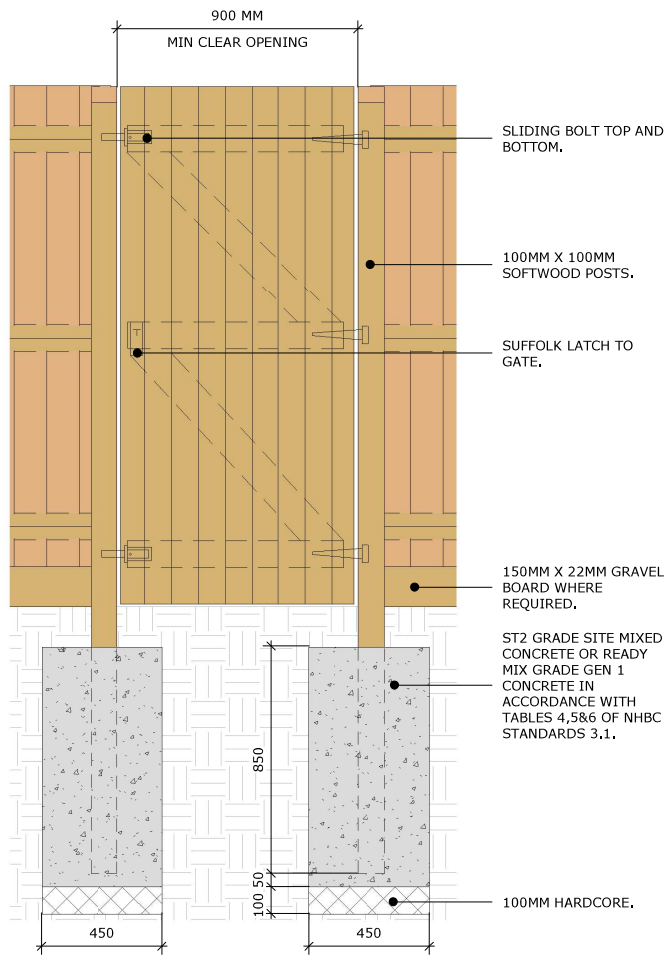

GATE ELEVATION

- NOTES:
- ALL TIMBER TO BE FSC AND IMPREGNATED WITH AN APPROVED PRESERVATIVE,
 - BUSINESS UNIT TO ASSESS SUITABILITY OF DETAIL FOR INDIVIDUAL DEVELOPMENTS AND CONSULT WITH STRUCTURAL ENGINEER ACCORDINGLY,
 - TO BE READ IN CONJUNCTION WITH BS1722 PART 5.

category EXTERNAL WORKS DETAILS							
description EXTERNAL WORKS - CLOSE BOARDED FENCE (1800MM)							
scale 1 : 20						revision 00	
project	originator	volume	level	type	role	Class	number
GROUP	VIS	S	EX	D2	A	FC	0213

Vistry Group

STANDARD DETAIL

SUBJECT TO NHBC APPROVAL