

PLEASE NOTE THAT THIS DRAWING IS NOT A CONSTRUCTION OR WORKING DRAWING AND HAS BEEN PRODUCED SOLELY FOR THE PURPOSES OF GAINING DEVELOPMENT CONTROL APPROVAL. CHRISTOPHER JAMES ARCHITECTURE TAKES NO RESPONSIBILITY FOR THEIR USE FOR ANY OTHER PURPOSE. ERRORS AND OMISSIONS TO BE REPORTED TO CHRISTOPHER JAMES ARCHITECTURE. THIS DRAWING IS COPYRIGHT

PLANNING
ISSUE

DRAWING KEY



Elevations to Proposed Bin Enclosure - 1:50 @ A1

Scale 1:50 @ A1

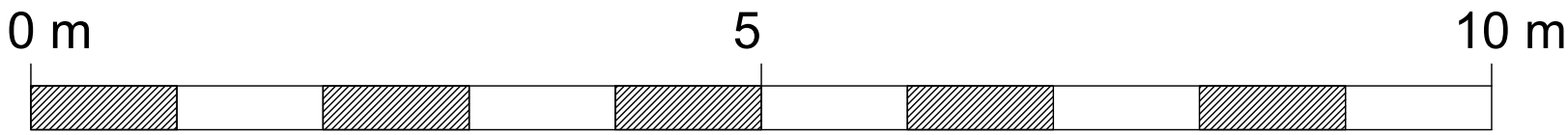

Scale 1:100 @ A1

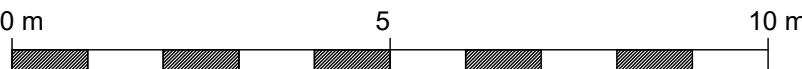

Proposed Part Site Plan and Ground Floor Plan - 1:100 @ A1

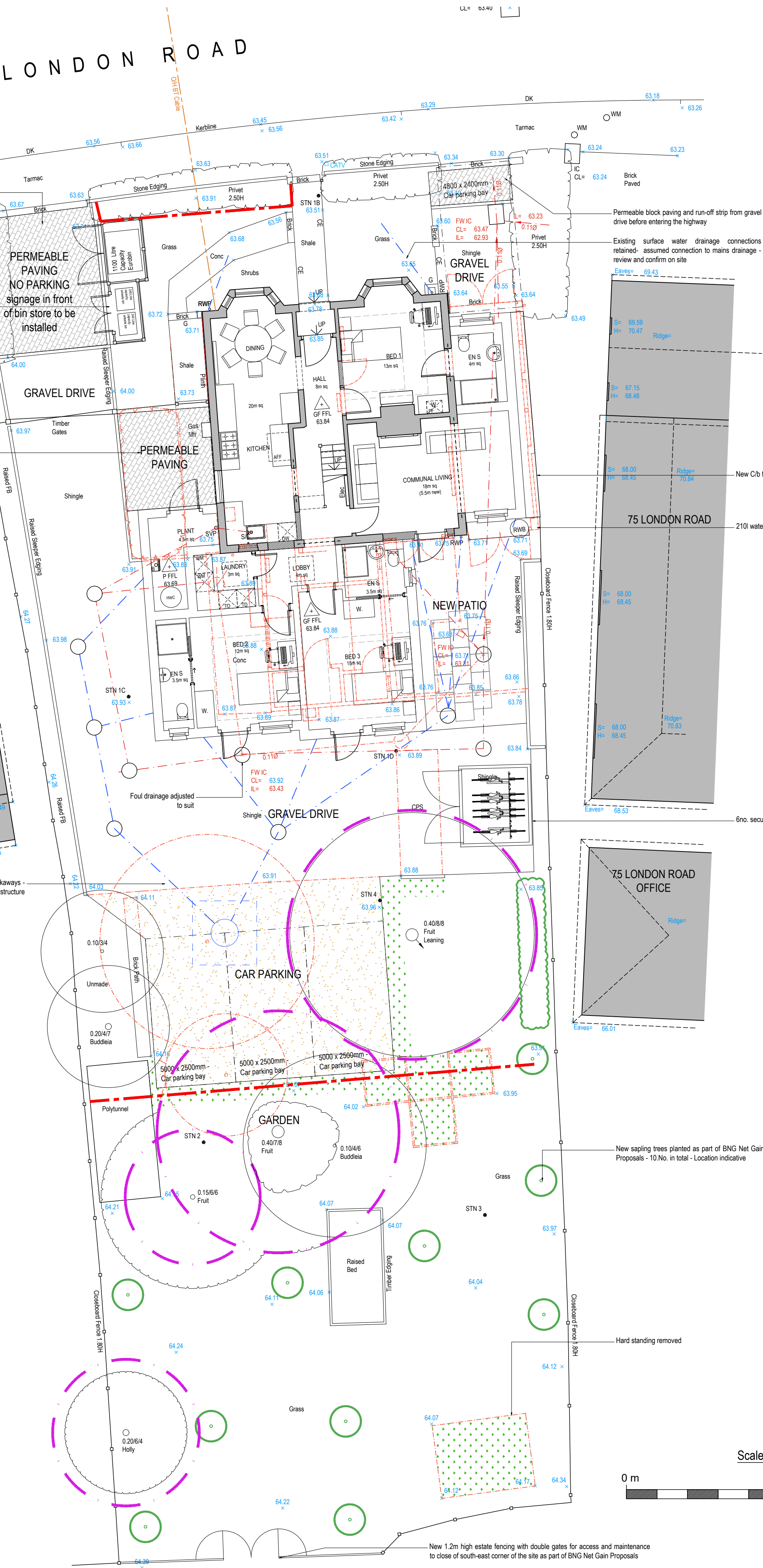

71 London Road, Wokingham - Proposed Extensions and Associated Internal Alterations

Proposed Site Plan

Scale as shown @ A1

Sept'24

350-1207-G



CHRISTOPHER JAMES ARCHITECTURE

27 Chaucer Way. Woosehill. Wokingham

Berkshire . RG41 3BG

T: 01189 797892 M: 07736039224

E: CHRIS@CHRISTOPHERJAMESARCHITECTURE.CO.UK