



Arboricultural Consultancy
Holmwood Farm Grange Horsham Road North Holmwood Dorking Surrey RH5 4JR
Tel: 01306 743374 Email: info@challiceconsulting.co.uk Web: www.challiceconsulting.co.uk

**Revision 3 of Tree Survey
Arboricultural Impact Assessment
Arboricultural Method Statement**

Relating to:

Land Adjacent to Yewcroft, The Bothy, Wargrave Hill,
Wargrave-on-Thames RG10 8JE

Produced for:

Mrs. Weatherlake

Prepared by:

Challice Consulting Ltd.
Mr. David Challice
Dip. Arb. (RFS), F. Arbor. A, MICFor
Chartered Arboriculturist

Date:

13th December 2025

Our Ref:

AR5887

Challice Consulting Ltd.
VAT Registration No. 886 2277 82
Registered Office: Ellis Atkins Chartered Accountants Constable Court 62 Dene Street
Dorking Surrey RH4 2DP United Kingdom
Registered in England and Wales No. 06080792

INTRODUCTION**SECTION**

Frequently Used Key Terms and Abbreviations	1.0
The Proposal	2.0
Instructions and Purpose	3.0
Scope	4.0
Documents Supplied/Used	5.0
Site Details	6.0

TREE SURVEY

Survey Method	7.0
Tree Details	8.0

ARBORICULTURAL IMPACT ASSESSMENT

Introduction to Arboricultural Impact Assessment	9.0
Tree Removal and Retention	10.0
Tree Pruning Works	11.0
Incursions into Root Protection Areas	12.0
Proximity Issues and Shading	13.0
Summary of Arboricultural Impact	14.0

ARBORICULTURAL METHOD STATEMENT

Introduction to Arboricultural Method Statement	15.0
Pre-Commencement Meeting	16.0
General Site Precautions	17.0
Tree Works	18.0
Tree Protective Fencing	19.0
Ground Protection	20.0
Site Access/Hard Surfaces	21.0
Demolition	22.0
Underground Services	23.0
Foundations	24.0
Construction/Hard Landscaping	25.0
Soft Landscaping/Boundary Fencing	26.0
Sequencing/Supervision, Responsibility and Incident Reporting	27.0
Amendments	28.0

Challice Consulting Ltd.

Holmwood Farm Grange Horsham Road North Holmwood Dorking Surrey RH5 4JR
Tel: 01306 743374 Email: info@challiceconsulting.co.uk Web: www.challiceconsulting.co.uk

APPENDICES

Appendix 1	Tree Survey Schedule with Recommended Tree Works
Appendix 2	Tree Protection Plan in Colour at A1 and Scale 1:200 with Tree Protective Fencing Specification
Appendix 3	Example of Site Inspection Record
Appendix 4	Induction Form for Personnel

INTRODUCTION

1.0 Frequently Used Key Terms and Abbreviations

Tree Preservation Order	TPO
Arboricultural Method Statement	AMS
British Standard 5837:2012 – Recommendations for Trees in Relation to Design, Demolition and Construction	BS 5837
British Standard 3998:2010 - Recommendations for Tree Work	BS 3998
Root Protection Area/Root Protection Areas	RPA/RPAs
Local Planning Authority	LPA

2.0 The Proposal

- 2.1 New single storey dwelling on land adjacent to Yewcroft, The Bothy.

3.0 Instructions and Purpose

- 3.1 This report has been commissioned by Mrs. Weatherlake to;
- Survey the trees in accordance with British Standard (BS 5837) 5837:2012 - Trees in Relation to Design, Demolition and Construction- Recommendations.
 - Make suggestions to decrease the arboricultural impact of the proposed scheme on the retained trees during the design process.
 - Detail the arboricultural impact of the proposed project.
 - Prepare a tree work schedule to British Standard (BS 3998) 3998:2010 - Recommendations for Tree Work.
 - Develop a tree protection strategy for the duration of the development including any demolition works.
- 3.2 Provision of the above information is designed to address the requirements of the LPA in terms of the arboricultural information necessary to register and determine the planning application.

4.0 Scope

- 4.1 In surveying the trees to the requirements of BS 5837, trees on and immediately adjacent to the site with a stem diameter over 75mm have been included. Large shrubs and hedges have been included where these are considered to be of significant amenity value. These are particularly important where they provide boundary screening. For clarity and ease of data interpretation, large shrubs have been classified as trees.
- 4.2 A full hazard assessment of the trees (including the assessment of decay or defects and their impact), has not been undertaken as this is

considered beyond the scope of this report. Any obvious hazards and defects have been identified in the Tree Survey Schedule and appropriate works recommended for immediate action.

- 4.3 It is the Client or their representative's responsibility to review the contents of this report to ensure it meets their requirements before it is sent to the Local Planning Authority.

5.0 Documents Supplied/Used

Document	Obtained From	Format/Ref.
Proposed layout plans	Ms. Tamsin Spens – Dunster Heat Ltd.	Dwg.
Topographical Survey	Mr. Bill Gething	Dwg.

6.0 Site Details

- 6.1 The site is comprised of a walled garden located to the east of Yewcroft, The Bothy, Wargrave Hill.
- 6.2 The site slopes gently from east to west.
- 6.3 The site is within the administrative jurisdiction of Wokingham Borough Council.
- 6.4 I have not been instructed to ascertain the protection status of any of the trees on or near the site.

TREE SURVEY

7.0 Survey Method

- 7.1 The site and trees were surveyed 25th January 2014, reviewed 3rd May 2018 and re-surveyed on 14th March 2024.
- 7.2 The trees were inspected from ground level and no climbing inspections were undertaken.

Challice Consulting Ltd.

Holmwood Farm Grange Horsham Road North Holmwood Dorking Surrey RH5 4JR
Tel: 01306 743374 Email: info@challiceconsulting.co.uk Web: www.challiceconsulting.co.uk

- 7.3 Stem diameters were measured using a diameter tape at 1.5m from ground level unless stated in the Tree Survey Schedule at **Appendix 1**. The locations of the surveyed trees have originated from the drawings supplied by the Client unless otherwise stated in the Tree Survey Schedule.

8.0 Tree Details

- 8.1 The total number of remaining tree records is as follows:
Individual Trees (T): 11
Tree Groups (G): 5
- 8.2 The tree details and proposed works are presented in the Tree Survey Schedule with Recommended Tree Works at **Appendix 1** and tree positions are shown on the Tree Protection Plan at **Appendix 2**.
- 8.3 The quality and value of the tree stock has been broken down by BS 5837 quality grade. The grading system can be summarised as follows:
A Grade – trees of high quality and value with a life expectancy of more than 40 years
B Grade – trees of moderate quality and value, with a life expectancy of more than 20 years
C Grade – trees of low quality and value, with a life expectancy of more than 10 years
U Grade – trees usually for removal (unless otherwise stated), with a life expectancy of less than 10 years

Quality and Value of Existing Tree Stock

	A Grade	B Grade	C Grade	U Grade
No. of Tree Records by Grade	1	4	11	0

- 8.4 The RPAs of the trees are included in the Tree Survey Schedule with reference to Table 1 of BS 5837. The RPA is the area, measured in m², which is calculated in accordance with the BS 5837 using the stem diameter of the trees. This should provide retained trees with sufficient rooting environment to survive the proposed development. Section 4.6.3

Challice Consulting Ltd.

Holmwood Farm Grange Horsham Road North Holmwood Dorking Surrey RH5 4JR
Tel: 01306 743374 Email: info@challiceconsulting.co.uk Web: www.challiceconsulting.co.uk

of BS 5837 provides for the shape of the RPA to be modified from the starting point of a circle to account for site features where rooting may be restricted, as long as the total area remains the same.

Diagrammatic Representation of a Restricted Root Protection Area

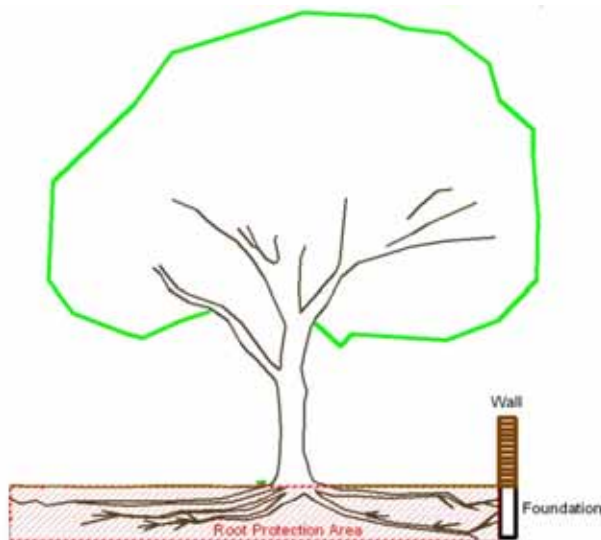

Modified RPAs

Tree No.	Impediments to Normal Rooting
G17 and T19	Existing hard surfacing and boundary wall

ARBORICULTURAL IMPACT ASSESSMENT

9.0 Introduction to Arboricultural Impact Assessment

9.1 This section comprises an assessment of the impact the proposed works detailed in Section 2 above have on trees. It considers the arboricultural impact and how this may be mitigated.

10.0 Tree Removal and Retention

10.1 The proposed scheme provides for the retention and protection of the following trees. These trees were chosen for their quality and suitability for retention within the context of the proposed development.

Trees to be Retained

	A Grade	B Grade	C Grade	U Grade
Tree No(s). To be Retained	T12	T1, T3, G17 and G18	T4, T5, T6, T7, T8, T9, T10, part of G14 and T19	N/a

- 10.2 The proposed scheme will require that the trees itemised in the Recommended Tree Works in **Appendix 1** and in the table below are removed. Such work will not impinge on the long-term character and appearance of the area subject to the implementation of a comprehensive landscaping scheme including tree planting, which is normally a standard condition of planning approval.

Trees to be Removed

	A Grade	B Grade	C Grade	U Grade
Tree No(s). To be Removed	0	0	G13, part of G14 and G15	N/a
Development Impact	None	None	Low	None

11.0 Tree Pruning Works

- 11.1 Minor tree pruning is recommended for good arboricultural practice and to ensure reasonable clearance from the proposed construction. The pruning described in the Tree Survey Schedule with Recommended Tree Works at **Appendix 1** will not adversely affect the trees or their contribution to local amenity.

12.0 Incursions into Root Protection Areas

- 12.1 There are no significant incursions into the RPAs of the retained trees within this scheme that require specialised building techniques.
- 12.2 Existing buildings are also to be demolished by hand adjacent to the RPAs of the retained trees particularly Copper Beech T12. These works will be undertaken in an arboriculturally sensitive manner as detailed in the AMS.

Challice Consulting Ltd.

Holmwood Farm Grange Horsham Road North Holmwood Dorking Surrey RH5 4JR
Tel: 01306 743374 Email: info@challiceconsulting.co.uk Web: www.challiceconsulting.co.uk

- 12.3 No new underground services are to be installed within the RPAs of the retained trees.

13.0 Proximity Issues and Shading

- 13.1 The approximate shade segments for key retained trees have been plotted using the ArborCAD software system, which identifies the approximate area of the site which may be affected by shade during the course of the day. The shade segment does not represent the area which will be in shade all day long; however, it represents an area which **may** be affected **at some point** during the course of a day by shade depending on the time of day and season.
- 13.2 The juxtaposition between retained trees and the proposed development is in accordance with Section 5.3 of the BS 5837 and should not lead to future pressure to heavily prune or remove retained trees for the following reasons:
1. Tree pruning has been recommended to provide adequate separation between the proposed development and the retained trees.
 2. Any future tree pruning works are unlikely to be over and above those generally accepted as good arboricultural practice in an urban environment.
 3. Low maintenance gutters can be specified to negate the need for removing leaves from the rainwater collection system.

14.0 Summary of Arboricultural Impact

- 14.1 In summary, the arboricultural impact of the proposed scheme is relatively minor as the majority of the trees to be removed are of low or moderate quality which will cause very little impact to the surrounding landscape.
- 14.2 I have assessed the impact of the proposed development and it is considered to be in line with the recommendations set out in British Standard 5837.
- 14.3 During the landscaping phase of the development there is an opportunity to plant trees in the space outside the development footprint to mitigate for those recommended for removal. These areas have been safeguarded

Challice Consulting Ltd.

Holmwood Farm Grange Horsham Road North Holmwood Dorking Surrey RH5 4JR
Tel: 01306 743374 Email: info@challiceconsulting.co.uk Web: www.challiceconsulting.co.uk

with tree protective fencing where possible to protect the planting medium in these areas.

- 14.4 The retained trees can be afforded an appropriate degree of protection in accordance with the BS 5837 as detailed in the AMS.

ARBORICULTURAL METHOD STATEMENT

15.0 Introduction to Arboricultural Method Statement

- 15.1 To safeguard the retained trees (both above and below ground parts) during the development works and preserve the soil structure of areas which could be allocated for new planting, it will be necessary to implement tree protection measures as outlined below.
- 15.2 The basic principle is that the area inside the tree protective fencing and where ground protection has been used is to be protected for the duration of the works.
- 15.3 A copy of this AMS shall be maintained on site at all times and made available to all site personnel.
- 15.4 All site personnel shall be made aware of the key impact of this AMS and be given an arboricultural induction by the Site Manager. An Induction Form is attached at **Appendix 4**. A copy of the Induction Form will be signed by all site personnel to confirm that they have understood the issues involved.
- 15.5 As of 2005, Local Planning Authorities have powers to serve **Temporary Stop Notices** if agreed tree protection measures are not carried out. Adhering to this AMS will ensure that such costly and time consuming action is avoided.

16.0 Pre-Commencement Meeting

- 16.1 A pre-commencement site meeting, involving representatives from the Development Company, the Arboricultural Consultant and the LPA Tree Officer will be held to ensure that all aspects of the tree protection process

Challice Consulting Ltd.

Holmwood Farm Grange Horsham Road North Holmwood Dorking Surrey RH5 4JR
Tel: 01306 743374 Email: info@challiceconsulting.co.uk Web: www.challiceconsulting.co.uk

are understood and agreed. A record of the meeting will be communicated to all parties by the Arboricultural Consultant within five days of the meeting.

- 16.2 Attendance at a pre-commencement site meeting and for any site supervision (see Section 27.0) is chargeable at the standard hourly rate as stated in the terms and conditions attached to the fee proposal for this report.

17.0 General Site Precautions

- 17.1 The following points will be observed at all times:
- No fires will be lit on site during the construction or demolition phases.
 - No access will be permitted inside the tree protective fencing.
 - No materials, equipment or debris will be stored within the tree protective fencing.
 - Notice boards, telephone cables or other services will not be attached to any parts of the retained trees.
 - Materials which will contaminate the soil (e.g. diesel oil and vehicle washings) will not be permitted to migrate into the RPAs of the retained trees.
 - A dedicated mixing and cleaning area will be set up to prevent concrete, cement and cleaning residue leaching into the RPAs of the retained trees (see Tree Protection Plan for specification).
 - Site cranes are to be automatically programmed to avoid loads striking the crowns, stems and branches of the retained trees.

18.0 Tree Works

- 18.1 All works will be carried out in accordance with BS 3998:2010 'Recommendations for Tree Work' (as amended) and to current arboricultural best practice. Tree works will be carried out by a suitably qualified and experienced Arboricultural Contractor holding the necessary insurance cover. This contractor should carry out the relevant site specific risk assessments and record such information prior to commencement of tasks and work in accordance with current health and safety standards,

Challice Consulting Ltd.

Holmwood Farm Grange Horsham Road North Holmwood Dorking Surrey RH5 4JR
Tel: 01306 743374 Email: info@challiceconsulting.co.uk Web: www.challiceconsulting.co.uk

practices and legislation. A list of such contractors is available from the Arboricultural Association at www.trees.org.uk.

- 18.2 The subject trees may be protected by virtue of being within a Conservation Area or covered by a TPO. Submission of this AMS in connection with a planning application should be construed as a formal application to carry out those works specified in the Tree Survey Schedule with Recommended Tree Works at **Appendix 1**. It is recommended that this matter be clarified by the Client in writing with the LPA prior to any works commencing.
- 18.3 In addition, prior to the commencement of any tree works, an ecological assessment of specific trees may be required to ascertain whether protected species (e.g. nesting birds, bats, badgers and certain invertebrates) may be affected.
- 18.4 Tree ownership should be clarified in writing by the Client before any trees are removed or pruned.
- 18.5 If additional pruning of trees is required to facilitate the proposed works or access for machinery/plant, the Arboricultural Consultant will be contacted to advise on appropriate works and liaise with the LPA as necessary.

19.0 Tree Protective Fencing

- 19.1 Tree protective fencing is used to ensure that the RPAs of the retained trees are safeguarded. These measures may also be employed to protect areas of ground for new landscaping.
- 19.2 The positioning and specification of the fencing is shown in **Appendix 2**. In this case, the default specification of BS 5837 consisting of **fixed Heras** fencing would be effective.
- 19.3 The protective fencing will remain in position for the duration of the development, including the removal of any existing structures. Clear signs will be attached to the fencing once erected – suggested wording will be **‘Construction Exclusion Zone No Access’**.

Challice Consulting Ltd.

Holmwood Farm Grange Horsham Road North Holmwood Dorking Surrey RH5 4JR
Tel: 01306 743374 Email: info@challiceconsulting.co.uk Web: www.challiceconsulting.co.uk

20.0 Ground Protection

- 20.1 In this instance, there is no requirement for ground protection as the RPAs of the retained trees can be afforded an adequate degree of protection using tree protective fencing and the existing hard surfacing.

21.0 Site Access/Hard Surfaces

- 21.1 The proposed vehicle access and proposed parking into the site is suitable for ingress during demolition and construction and little or no damage is anticipated to the root systems of the retained trees.
- 21.2 There is a minor incursion into the RPA of Copper Beech T12 to allow the construction of the timber deck, however, there is sufficient rooting area available on site that is protected by the Tree Protective Fencing.

22.0 Demolition

- 22.1 The existing buildings will be demolished by hand using the 'top down, pull back' method as recommended in BS 5837. This is achieved by demolishing the structure into its own space onto the existing foundation. Existing hard surfacing and shed bases within the RPAs of the retained trees will be removed using the same procedure under direct arboricultural supervision to prevent the roots below the surfacing from being damaged. Tree protective fencing will need to be relocated to achieve this, however, the fencing will be returned to the location shown on the Tree Protection Plan following completion of the demolition.

23.0 Underground Services

- 23.1 The proposed scheme can make use of existing services located inside and outside the site boundary and all new services and soakaways will be located in the adequate space outside the RPAs of the retained trees.
- 23.2 The locations, specifications and installation methods of all new services will be available for review at the pre-commencement site meeting before any works start on site.

Challice Consulting Ltd.

Holmwood Farm Grange Horsham Road North Holmwood Dorking Surrey RH5 4JR
Tel: 01306 743374 Email: info@challiceconsulting.co.uk Web: www.challiceconsulting.co.uk

24.0 Foundations

- 24.1 The foundations for the proposed development are located outside the RPAs of the retained trees, therefore, the design and installation of specialised foundations is not required.

25.0 Construction/Hard Landscaping

- 25.1 In this instance, retained trees will not impede the erection of scaffolding and no ancillary structures are proposed within the RPAs of the retained trees.
- 25.2 Subject to all of the above tree protection measures being implemented, construction works may proceed without risk of damage to the retained trees.

26.0 Soft Landscaping/Boundary Fencing

- 26.1 Soft landscaping will be undertaken when heavy machinery has been removed from site and tree protective fencing taken down. The following points will be observed:
- Care will be taken not to compact the soil within the RPAs of the retained trees or where new tree planting is to be carried out.
 - No changes in ground levels will occur within the RPAs of the retained trees.
 - Unwanted vegetation will be removed manually or using contact herbicides that will not damage existing tree roots.
 - No irrigation or drainage pipes will be installed within the RPAs of the retained trees.
 - If soil has been compacted in areas where planting is proposed, measures to improve soil structure (e.g. decompaction) may be necessary to facilitate successful plant establishment.
 - Where deck, fence and gate post holes are to be installed within the RPAs of the retained trees, they shall be lined with heavy duty Polythene to prevent the harmful cement leaching into the soil and damaging the roots of the retained trees.

27.0 Sequencing/Supervision, Responsibility and Incident Reporting

- 27.1 Effective tree protection relies on following a logical sequence of events and arboricultural inspection/supervision.
- 27.2 Works which have the potential to affect trees will be supervised by a suitably qualified and experienced Arboricultural Consultant. Regular inspection visits will also be undertaken to ensure that tree protection measures are being adhered to. The final details of supervision and the frequency of inspection visits will be agreed with the Tree Officer at the pre-commencement meeting. The Arboricultural Consultant will make a record of visits, which will be attached to the site copy of the AMS for inspection and communicated in writing to the LPA within five days of the site visit. An example of the Site Inspection Record is found in **Appendix 3**.
- 27.3 Daily inspection of the physical tree protection measures will be carried out by the on-site Arboricultural Liaison, who does not have to be a trained Arborist, but will be responsible for the implementation of the approved tree protection. Any deviation from the approved methodologies will need to be agreed by the Arboricultural Consultant who may need to visit site to authorise the revised tree protection measures. It is the responsibility of the Client or the Arboricultural Liaison to instruct the Arboricultural Consultant to attend site for the key events requiring supervision or monitoring.
- 27.4 Any damage to stems, branches or any size roots of the retained trees will be reported immediately by email and telephone by the Arboricultural Liaison to the Arboricultural Consultant. The Arboricultural Liaison will take photographs of the damage and send these to the Arboricultural Consultant who will visit site to assess the scale of the damage and report to the LPA Tree Officer. Mitigation for the damage will be agreed with the LPA Tree Officer.

Sequencing and Supervision

Stage	Action/Task	Personnel Responsible
1.	Issue arboricultural report to site manager	Client/Developer
2.	Give Arboricultural Consultant (AC) at least a week's notice of pre-commencement meeting	Client/Developer
3.	Pre-commencement meeting	Site Manager, Tree Officer and AC
4.	Arboricultural induction and appointment of the Arboricultural Liaison	Site Manager
5.	Carry out tree works (the Client is to establish tree ownership and protection status in writing before any tree works are carried out)	Client
6.	Erect tree protective fencing	AC to inspect
7.	Carry out demolition of the sheds by hand within the RPAs of the retained trees	AC to supervise
8.	Construct foundations	Site Manager
9.	Install underground services	AC to supervise
10.	Erect scaffolding and carry out construction (including hard landscaping)	Site Manager
11.	Remove machinery/plant	Site Manager
12.	Remove tree protective fencing	Site Manager
13.	Carry out soft/hard landscaping and erect boundary fencing	Site Manager to brief landscaping company on site and supervise

28.0 Amendments

- 28.1 Issues sometimes arise on development sites which require amendments to the previously agreed tree protection details. Any amendments to this AMS will be discussed with the Arboricultural Consultant and approved in writing by the LPA prior to being implemented. Copies of paperwork relating to any amendments shall be attached to the site copy of the AMS to provide a definitive record of what has been agreed.

Challice Consulting Ltd.

Holmwood Farm Grange Horsham Road North Holmwood Dorking Surrey RH5 4JR
Tel: 01306 743374 Email: info@challiceconsulting.co.uk Web: www.challiceconsulting.co.uk

Appendix 1

Site: Land Adjacent to Yewcroft, The Bothy, Wargrave Hill, Wargrave-on-Thames RG10 8JE

Surveyors: Mr. Don Newling and Mr. David Challice

Surveyed 25/01/2014, Reviewed 03/05/2018 and Surveyed 14/03/2024

Our Ref: CC/1163 AR2103, AR3646 and AR5406

Tree No.	English Name	Height	Crown Spread	Ground Clearance	Age Class	Stem Diameter	Protection Multiplier	Protection Radius	Growth Vitality	Structural Condition	Landscape Contribution	B.S. Cat	Sub Cat	Useful Life	Observations
T1	Common Oak 1 Number	16	6 4 6 4 4	GC 2 FB 0.5 N	Mature	556 3	12	6.7	Moderate	Fair	Medium	B	2	40+	Triple stemmed
<u>Recommended Works/Reason for Works:</u>		No work proposed													
G2	Trees Removed 4 Number			GC FB											
<u>Recommended Works/Reason for Works:</u>															
T3	Common Oak 1 Number	9	6 5 6 5 5	GC 1.5 FB 1 W	Early Mature	350 1	12	4.2	Normal	Fair	Medium	B	2	40+	A tree with insignificant defects
<u>Recommended Works/Reason for Works:</u>		Cut back to give 2m clearance from dwelling													
T4	Silver Birch 1 Number	13	4 4 3 4 3	GC 2 FB 2 S	Early Mature	230 1	12	2.8	Normal	Poor	Medium	C	2	10+	Old basal wound/cavity Basal sucker Old crown wound/cavity where original leader lost in past storm
<u>Recommended Works/Reason for Works:</u>		Inspect annually													
T5	Flowering Cherry 1 Number	7	3 5 7 5 5	GC 2 FB 1.5 N	Early Mature	270 1	12	3.2	Normal	Fair	Medium	C	2	20+	Trunk wound where stem has fallen
<u>Recommended Works/Reason for Works:</u>		No work proposed													

Notes:

- Height describes the approximate height of the tree measured in meters from ground level.
- The Crown Spread refers to the crown radius in meters from the stem centre and is shown above on each of the four compass points (i.e. N, S, E, W).
- Ground Clearance (**GC**) is the height in meters of crown clearance above adjacent ground level, the height of the first significant branch (**FB**) and the direction in which it is growing.
- Stem Diameter is the diameter of the stem measured in millimeters at 1.5m from ground level. The stem diameter may be estimated (**est**) where access is restricted or an average (**ave**) taken for groups or multi-stemmed trees with more than five stems. The number of stems is also indicated.
- Protection Multiplier is the number used to calculate the tree's protection radius and area and is shown as 12.

- Protection Radius is a radial distance measured from the trunk centre.
- Growth Vitality - Normal growth, Moderate (below normal), Poor (sparse/weak) or Dead (dead or dying tree).
- Structural Condition - Good (no or only minor defects), Fair (remedial defects), Poor (major defects present).
- Landscape Contribution - High (prominent landscape feature), Medium (visible in landscape), Low (secluded/among other trees).
- B.S. Cat refers to British Standard 5837:2012 Table 1 and refers to tree/group quality and value; 'A' - High, 'B' - Moderate, 'C' - Low, 'U' - Remove.
- Sub Cat refers to the retention criteria values where 1 is Arboricultural, 2 is Landscape and 3 is Cultural including Conservation, Historic and Commemorative.
- Useful Life is the tree's estimated remaining contribution in years.

Site: Land Adjacent to Yewcroft, The Bothy, Wargrave Hill, Wargrave-on-Thames RG10 8JE

Surveyors: Mr. Don Newling and Mr. David Challice

Surveyed 25/01/2014, Reviewed 03/05/2018 and Surveyed 14/03/2024

Our Ref: CC/1163 AR2103, AR3646 and AR5406

Tree No.	English Name	Height	Crown Spread	Ground Clearance	Age Class	Stem Diameter	Protection Multiplier	Protection Radius	Growth Vitality	Structural Condition	Landscape Contribution	B.S. Cat	Sub Cat	Useful Life	Observations
T6	Whitebeam 1 Number	10	2 4 4 4	GC 3 FB 3 S	Early Mature	300 1	12	3.6	Normal	Fair	Medium	C	2	20+	Multi-stemmed at 1.6m Occluded unions Minor deadwood in lower crown Partially suppressed by T7
<u>Recommended Works/ Reason for Works:</u>		No work proposed													
T7	Whitebeam 1 Number	10	3 5 5 2	GC 3 FB 1.5 E	Early Mature	310 1	12	3.7	Normal	Fair	Medium	C	2	20+	Multi-stemmed at 1.6m Occluded unions Minor deadwood in lower crown Partially suppressed by T6 and T8
<u>Recommended Works/ Reason for Works:</u>		No work proposed													
T8	Whitebeam 1 Number	9	2 4 4 4	GC2.5 FB 1.5 S	Early Mature	240 1	12	2.9	Normal	Fair	Medium	C	2	20+	Multi-stemmed at 1.6m Occluded unions Minor deadwood in lower crown Partially suppressed by T9
<u>Recommended Works/ Reason for Works:</u>		No work proposed													
T9	Whitebeam 1 Number	9	1 4 5 3	GC2.5 FB 2 N	Early Mature	260 1	12	3.1	Normal	Fair	Medium	C	2	20+	Twin leader Occluded union Minor deadwood in lower crown Partially suppressed by T8 and T10
<u>Recommended Works/ Reason for Works:</u>		No work proposed													
T10	Whitebeam 1 Number	8	3 4 4 2	GC 2 FB 2 E	Early Mature	270 1	12	3.2	Normal	Fair	Medium	C	2	20+	Co-dominant leader Occluded union Minor deadwood in lower crown
<u>Recommended Works/ Reason for Works:</u>		No work proposed													

Notes:

- Height describes the approximate height of the tree measured in meters from ground level.
- The Crown Spread refers to the crown radius in meters from the stem centre and is shown above on each of the four compass points (i.e. N, S, E, W).
- Ground Clearance (**GC**) is the height in meters of crown clearance above adjacent ground level, the height of the first significant branch (**FB**) and the direction in which it is growing.
- Stem Diameter is the diameter of the stem measured in millimeters at 1.5m from ground level. The stem diameter may be estimated (**est**) where access is restricted or an average (**ave**) taken for groups or multi-stemmed trees with more than five stems. The number of stems is also indicated.
- Protection Multiplier is the number used to calculate the tree's protection radius and area and is shown as 12.

- Protection Radius is a radial distance measured from the trunk centre.
- Growth Vitality - Normal growth, Moderate (below normal), Poor (sparse/weak) or Dead (dead or dying tree).
- Structural Condition - Good (no or only minor defects), Fair (remedial defects), Poor (major defects present).
- Landscape Contribution - High (prominent landscape feature), Medium (visible in landscape), Low (secluded/among other trees).
- B.S. Cat refers to British Standard 5837:2012 Table 1 and refers to tree/group quality and value; 'A' - High, 'B' - Moderate, 'C' - Low, 'U' - Remove.
- Sub Cat refers to the retention criteria values where 1 is Arboricultural, 2 is Landscape and 3 is Cultural including Conservation, Historic and Commemorative.
- Useful Life is the tree's estimated remaining contribution in years.

Site: Land Adjacent to Yewcroft, The Bothy, Wargrave Hill, Wargrave-on-Thames RG10 8JE

Surveyors: Mr. Don Newling and Mr. David Challice

Surveyed 25/01/2014, Reviewed 03/05/2018 and Surveyed 14/03/2024

Our Ref: CC/1163 AR2103, AR3646 and AR5406

Tree No.	English Name	Height	Crown Spread	Ground Clearance	Age Class	Stem Diameter	Protection Multiplier	Protection Radius	Growth Vitality	Structural Condition	Landscape Contribution	B.S. Cat	Sub Cat	Useful Life	Observations
T11	Tree Removed 1 Number			GC FB											
Recommended Works/Reason for Works:															
T12	Copper Beech 1 Number	16	6 6 8 8	GC 2 FB 4 E	Mature	680 1	12	8.2	Normal	Fair	High	A	2	40+	Old trunk wound which is well occluded, possibly fire damage Misshapen crown Partially suppressed by G17
Recommended Works/Reason for Works: No work proposed															
G13	Cultivated Apple 2 Number	4	3 3 3 3	GC0.5 FB 0.5 S	Early Mature	190 1 ave	12	2.3	Normal	Fair	Low	C	2	10+	Partially suppressed
Recommended Works/Reason for Works: Remove and replace Recommended to permit development															
G14	Irish Yew, Common Yew and Young Shrubs approx 12 Number	3	2 2 2 2	GC 0 FB 0.5 N	Semi-Mature	50 1 ave	12	0.6	Normal	Fair	Low	C	2	20+	Partially suppressed by dense shrubs and young self set trees Trees plotted on plan by eye Not all trees plotted on plan
Recommended Works/Reason for Works: Remove and replace part of the group Recommended to permit development															
G15	Ornamental Evergreen Shrubs 4 Number	4	3 3 3 3	GC 0 FB 0.5 N	Early Mature	120 1 est	12	1.4	Normal	Fair	Low	C	2	20+	Not all trees plotted on plan Useful boundary screening trees
Recommended Works/Reason for Works: Remove and replace Recommended to permit development															

Notes:

- Height describes the approximate height of the tree measured in meters from ground level.
- The Crown Spread refers to the crown radius in meters from the stem centre and is shown above on each of the four compass points (i.e. N, S, E, W).
- Ground Clearance (**GC**) is the height in meters of crown clearance above adjacent ground level, the height of the first significant branch (**FB**) and the direction in which it is growing.
- Stem Diameter is the diameter of the stem measured in millimeters at 1.5m from ground level. The stem diameter may be estimated (**est**) where access is restricted or an average (**ave**) taken for groups or multi-stemmed trees with more than five stems. The number of stems is also indicated.
- Protection Multiplier is the number used to calculate the tree's protection radius and area and is shown as 12.

- Protection Radius is a radial distance measured from the trunk centre.
- Growth Vitality - Normal growth, Moderate (below normal), Poor (sparse/weak) or Dead (dead or dying tree).
- Structural Condition - Good (no or only minor defects), Fair (remedial defects), Poor (major defects present).
- Landscape Contribution - High (prominent landscape feature), Medium (visible in landscape), Low (secluded/among other trees).
- B.S. Cat refers to British Standard 5837:2012 Table 1 and refers to tree/group quality and value; 'A' - High, 'B' - Moderate, 'C' - Low, 'U' - Remove.
- Sub Cat refers to the retention criteria values where 1 is Arboricultural, 2 is Landscape and 3 is Cultural including Conservation, Historic and Commemorative.
- Useful Life is the tree's estimated remaining contribution in years.

Site: Land Adjacent to Yewcroft, The Bothy, Wargrave Hill, Wargrave-on-Thames RG10 8JE

Surveyors: Mr. Don Newling and Mr. David Challice

Surveyed 25/01/2014, Reviewed 03/05/2018 and Surveyed 14/03/2024

Our Ref: CC/1163 AR2103, AR3646 and AR5406

Tree No.	English Name	Height	Crown Spread	Ground Clearance	Age Class	Stem Diameter	Protection Multiplier	Protection Radius	Growth Vitality	Structural Condition	Landscape Contribution	B.S. Cat	Sub Cat	Useful Life	Observations
T16	Tree Removed 1 Number			GC FB											
Recommended Works/Reason for Works:															
G17	Sycamore, Horse Chestnut and Common Beech 8 Number	18	8 8 8	GC 2 FB 2 S	Mature	700 1 est	12	8.4	Normal	Fair	Medium	B	2	20+	Trees located off site
Recommended Works/Reason for Works: No work proposed															
G18 approx	Common Yew 15 Number	3	1 1 1	GC0.5 FB 0.5 N	Semi-Mature	150 1 est	12	1.8	Normal	Good	Medium	B	2	20+	Not all trees plotted on plan Useful boundary screening trees Maintained as a hedge
Recommended Works/Reason for Works: No work proposed															
T19	Flowering Cherry 1 Number	8	5 3 5	GC 3 FB 2 N	Mature	390 1	12	4.7	Moderate	Poor	Medium	C	2	10+	Significant stem decay
Recommended Works/Reason for Works: No work proposed															

Notes:

- Height describes the approximate height of the tree measured in meters from ground level.
- The Crown Spread refers to the crown radius in meters from the stem centre and is shown above on each of the four compass points (i.e. N, S, E, W).
- Ground Clearance (**GC**) is the height in meters of crown clearance above adjacent ground level, the height of the first significant branch (**FB**) and the direction in which it is growing.
- Stem Diameter is the diameter of the stem measured in millimeters at 1.5m from ground level. The stem diameter may be estimated (**est**) where access is restricted or an average (**ave**) taken for groups or multi-stemmed trees with more than five stems. The number of stems is also indicated.
- Protection Multiplier is the number used to calculate the tree's protection radius and area and is shown as 12.

- Protection Radius is a radial distance measured from the trunk centre.
- Growth Vitality - Normal growth, Moderate (below normal), Poor (sparse/weak) or Dead (dead or dying tree).
- Structural Condition - Good (no or only minor defects), Fair (remedial defects), Poor (major defects present).
- Landscape Contribution - High (prominent landscape feature), Medium (visible in landscape), Low (secluded/among other trees).
- B.S. Cat refers to British Standard 5837:2012 Table 1 and refers to tree/group quality and value; 'A' - High, 'B' - Moderate, 'C' - Low, 'U' - Remove.
- Sub Cat refers to the retention criteria values where 1 is Arboricultural, 2 is Landscape and 3 is Cultural including Conservation, Historic and Commemorative.
- Useful Life is the tree's estimated remaining contribution in years.

Appendix 2

Examples of above-ground stabilizing systems for protective barriers

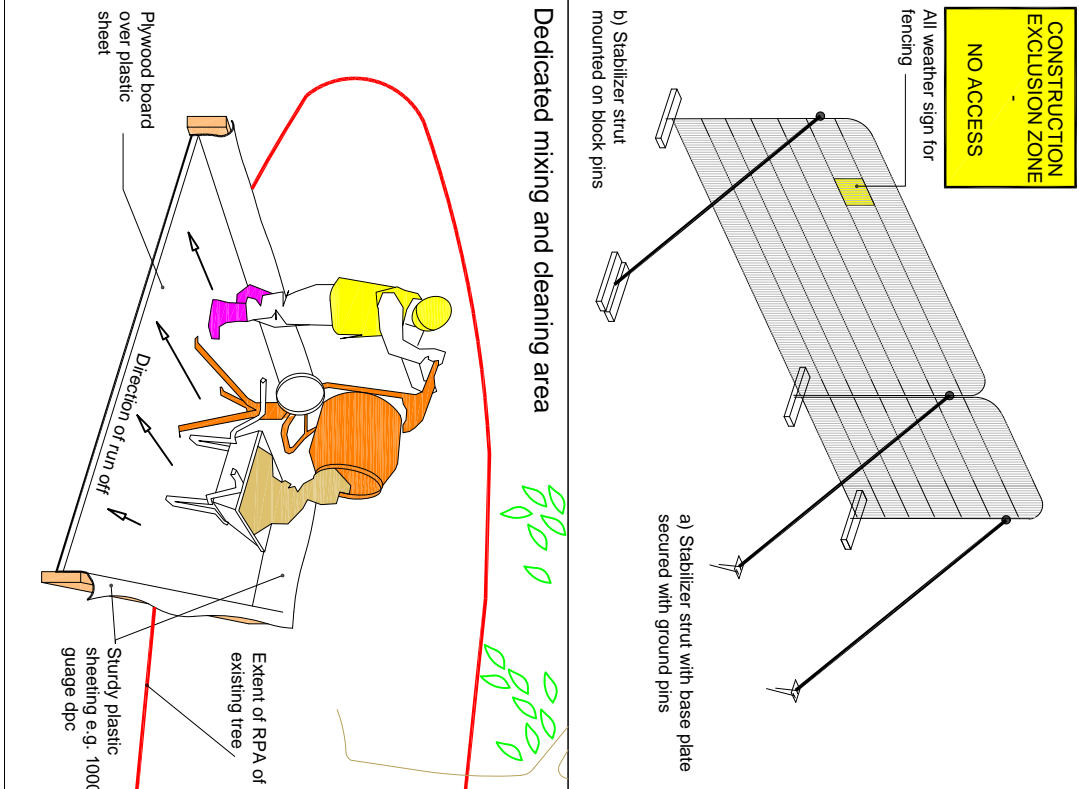

THIS PLAN TO BE USED FOR SETTING OUT OF TREE PROTECTION MEASURES ONLY; DO NOT SCALE FROM THIS PLAN UNLESS IT IS PRINTED AT A1. DO NOT USE UNLESS PRINTED IN COLOUR

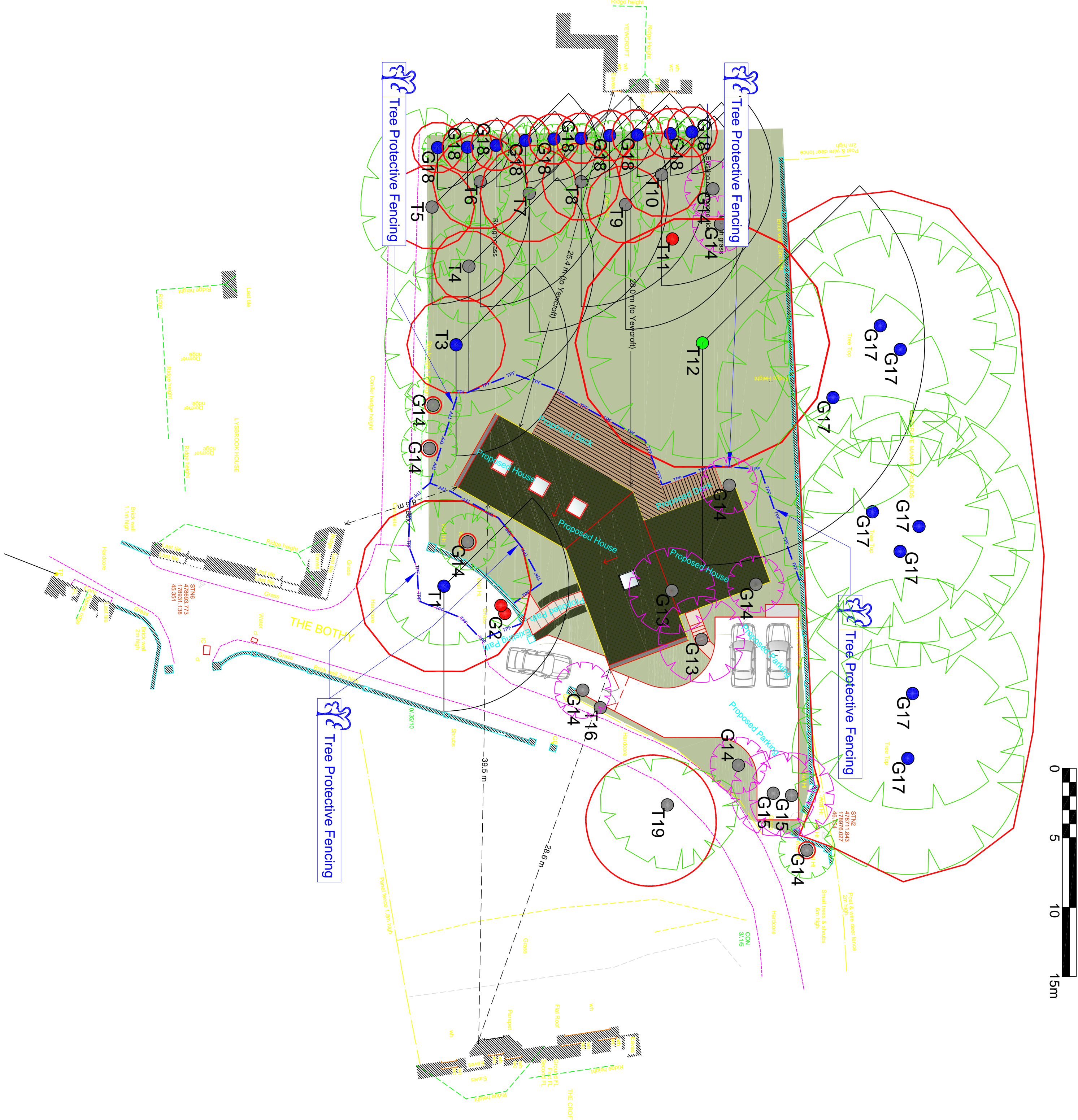

KEY:

	Stake patterns for key retained trees
	BS rooting area is shown to account for site features
	BS rooting area has been features
	A Grade
	B Grade
	C Grade
	Site of removed U Grade trees
	Trees to be removed
	Position of fixed Hiera style fencing

Challice Consulting Ltd.
01253 810000
www.challiceconsulting.co.uk

Notes:

Tree protection barrier to be erected and installed before machinery or materials are brought onto site, before any demolition or development of land and before soil stripping.

Tree protection measures should be implemented following any necessary pre-development tree work.

Barriers must not be removed or altered except with prior recommendation by project arboriculturist and where necessary, approval from the Local Planning Authority.

Setting out to be confirmed by project arboriculturist prior to commencement of other operations.

Plan to be printed in colour and to scale			
Tree Protection Plan			
Land Adjacent to Yewcroft, Wargrave-on-Thames RG10 8JE			
SCALE	DATE	DESIGNED BY	REV
1:200 @ A1	13.12.2025	D.C.	3
TTP-AR5887			

Challice Consulting Ltd.
Holmwood Farm Garage
North Holmwood
Dorking
Surrey
RH5 4JR
Tel: 01306 743374
Email: info@challiceconsulting.co.uk
Web: www.challiceconsulting.co.uk

Appendix 3



Arboricultural Consultancy
Holmwood Farm Grange Horsham Road North Holmwood Dorking Surrey RH5 4JR
Tel: 01306 743374 Email: info@challiceconsulting.co.uk Web: www.challiceconsulting.co.uk

(Sample) Arboricultural Site Supervision Record

Our Ref: ARxxxx

Site: xxxx

Application Number: xxxx/xxxx

Proposal: Front boundary wall, entrance gates and hard and soft landscaping.

Inspected by: Mr. David Challice

Date of Inspection: xx/xx/xxxx

Client: Mr. xxxx

Site Contact: Mr. xxxx

Local Authority: xxxx

Persons Present:

Mr. David Challice - Tree Consultant

Mr. xxxx – Landscape Architect

Tree Protective Fencing:

The tree protective fencing was installed according to the approved documentation.

Photograph of the Tree Protective Fencing



Works Within the Construction Exclusion Zone:

During the site meeting, the screw piles were installed under arboricultural supervision to discharge Condition 6 of the planning application reference xxxx/xxxx (drawing reference xxxxxx-x) for the approved boundary wall. This was undertaken as per the agreed specification to protect the roots of the off site hedge G8.

Photograph of the Screw Pile Installation within the Rooting Areas of Off Site Trees**Amendments to the Approved Arboricultural Documentation:**

There is no requirement for any amendments to the approved arboricultural documentation.

Remedial Work:

There is no requirement for any remedial tree works at this time as all the tree protective measures were installed according to the approved documentation.

General Comments:

I recommend that no further arboricultural site monitoring is required for this project. This report should be emailed by the Client to the Local Planning Authority.

Date of the Next Arboricultural Inspection:

No further arboricultural inspections are required.

Appendix 4

Induction Form for all Site Personnel:

Site Name:

- I have had explained to me by the Site Manager the key implications of the Arboricultural Method Statement relating to the development at the above site.
- I am aware that the tree protective fencing must remain in its original position and must not be moved without the approval of the appointed Arboricultural Consultant.
- I understand that certain operations must be supervised by the appointed Arboricultural Consultant and that these operations must not start until the consultant is present and has given approval.
- I confirm that I will bring any concerns about potential damage to trees to the attention of the Site Manager.
- I am aware that I must not cause damage to any of the retained trees on or adjacent to the site. Damage may be caused by direct means (i.e. physical damage caused to roots or the trunk/branches of the tree) or by indirect means (e.g. by fire or toxic materials entering the rooting environment of the tree).

Print Name:

Sign Name:

Date: