

© BEAL Consulting Engineers Ltd. All rights reserved.
No part of this document may be reproduced, stored in a retrieval system or transmitted, in any form or by means, electronic, mechanical, photocopying, recording or otherwise, without the prior permission of BEAL Consulting Engineers Ltd.

NOTES:

- Do not scale from this drawing. This drawing shall be read in conjunction with all other relevant Architect's and Engineer's drawings.
- Any discrepancies, ambiguities, or anomalies in the information provided on this or any of the engineering drawings package must be reported prior to work proceeding.
- All accommodation work deemed necessary to facilitate a satisfactory link between the new works and the existing to be undertaken by the developer.
- It is the contractor's responsibility to locate all existing services and verify their level & location prior to commencing any works. Should they be affected by the works then the respective statutory undertaker should be contacted and any special protection requirements agreed.
- All highway works shall be undertaken in accordance with the Local Highway Authorities Design Guide and Specification and strictly in accordance with the 'Specification for Highway Works'. All drainage works shall be undertaken in accordance with the 'Design & Construction Guidance', and any other Regional Water company requirements. All works to be supervised/inspected as required by the relevant Inspector.
- All works must comply with current Health and Safety guidance & standards. All temporary signing to comply with Traffic Signs Manual - Chapter 8.
- All products are to be installed and maintained strictly in accordance with manufacturer's recommendations & guidelines.

Note

The proposals as shown are all subject to the prior approval of the Local Planning Authority, Local Highway Authority and Local Water Authority. No works to the adopted highway or drainage network must be undertaken until technical approval has been granted for the respective element.

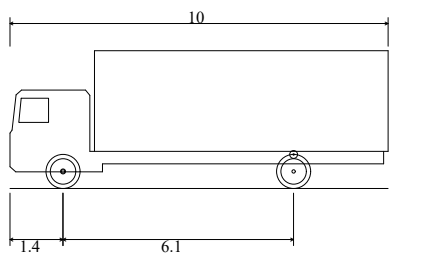

FTA Design 13/18
Tonne Rigid Vehicle (2016)
Overall Length 10.000m
Overall Width 2.550m
Overall Body Height 3.645m
Min Body Ground Clearance 0.440m
Track Width 2.470m
Lock to lock time 3.00s
Kerb to Kerb Turning Radius 11.000m

PRELIMINARY

Rev: Date: Description:

Client:



Project:

Victoria Road,
Wargrave

Drawing Title:

Tracking Layouts
Delivery (Construction)



Haddenham Business Centre,
Chiltern House,
Thame Road,
Haddenham,
Bucks, HP17 8BY.
01844 396233
www.beal-uk.com

Designed: Drawn: SH Checked:

Scale: 1:200 @ A1 Date: Jan 2026 Approved:

Drawing Number: 690:015 Revision: -