

VOLUME CALCULATION FOR DORMER

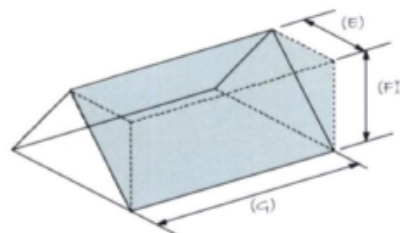

PROPOSED SECOND FLOOR PLAN 1 : 50

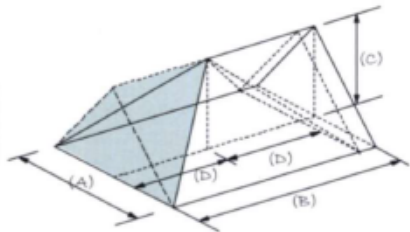
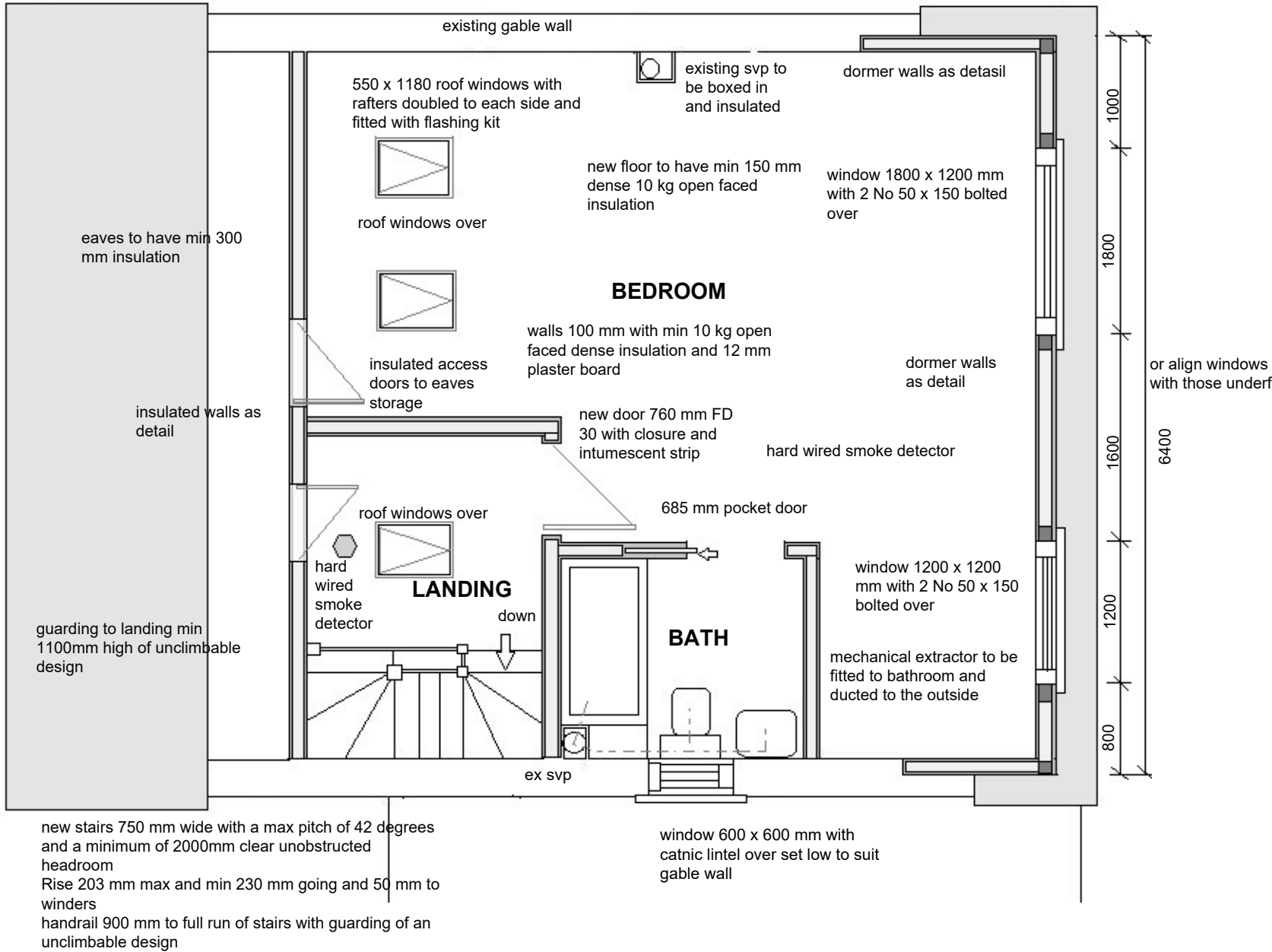

Calculation for roof volume
(Hip to gable with rear dormer)

	Metres
A	Depth of main roof
B	Width of main roof
C	Height of main roof
D	Ridge to eaves in plan
E	Projection of rear dormer
F	Height of rear dormer
G	Width of rear dormer

Volume of the triangular prism
Area of the triangle x its length
(A x C / 2 x (D x 2)) - cubic metres

Volume of the pyramid
Base area x 1/3 height
(A x (D x 2) x 1/3 C) - cubic metres

Volume of the additional segment
Hip to Gable
(Prism - Pyramid) / 2 - cubic metres

Volume of the additional rear dormer
area of the triangle x its length
(E x F / 2 x G) 36.96 cubic metres

TOTAL volume of development in the roof 36.96 cubic metres

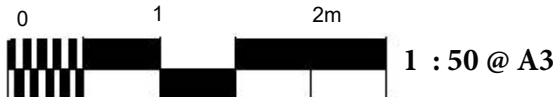
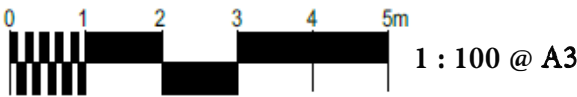

SBS

Surrey Building Services
Architectural & Building Consultants

James Templeman : 07793433353 Email : surreybuildingservices@gmail.com

Client No.	No.	Revision
11381	09	BR

Client Name : Mrs Howe

Address
12 Heather Close
Finchampstead
Berks
RG40 4 PX

Proposal

PROPOSED LOFT CONVERSION WITH
REAR DORMER

Scale 1:100 1:50

Paper Size A3