

DISCLAIMER NOTE

ADJACENT PROPERTIES AND BOUNDARIES ARE SHOWN FOR ILLUSTRATIVE PURPOSES ONLY AND HAVE NOT BEEN SURVEYED UNLESS OTHERWISE STATED.

ALL AREAS SHOWN ARE APPROXIMATE AND SHOULD BE VERIFIED BEFORE FORMING THE BASIS OF A DECISION.

DO NOT SCALE OTHER THAN FOR PLANNING APPLICATION PURPOSES.

ALL DIMENSIONS MUST BE CHECKED BY THE **CONTRACTOR** BEFORE COMMENCING WORK ON SITE.

NO DEVIATION FROM DRAWING WILL BE PERMITTED WITHOUT THE PRIOR WRITTEN CONSENT OF **ASDOT DESIGN**.

THE COPYRIGHT OF THIS DRAWING REMAINS WITH **ASDOT DESIGN** AND MAY NOT BE REPRODUCED IN ANY FORM.

GROUND FLOOR SLABS, FOUNDATIONS, SUBSTRUCTURES, ETC. ALL WORK BELOW GROUND LEVEL IS SHOWN PROVISIONALLY. INSPECTION OF GROUND CONDITIONS IS ESSENTIAL PRIOR TO WORK COMMENCING.

REASSESSMENT IS ESSENTIAL IF THE GROUND CONDITIONS ARE APPARENT, AND REDRAWAL MAY BE NECESSARY IN THE LIGHT OF SUCH REASSESSMENT.

THESE DRAWINGS ARE NOT TO BE USED FOR ESTABLISHING THE SIZE AND NATURE OF THE WORK OR SUB-SOIL CONDITIONS PESTS WITH THE **CONTRACTORS**.

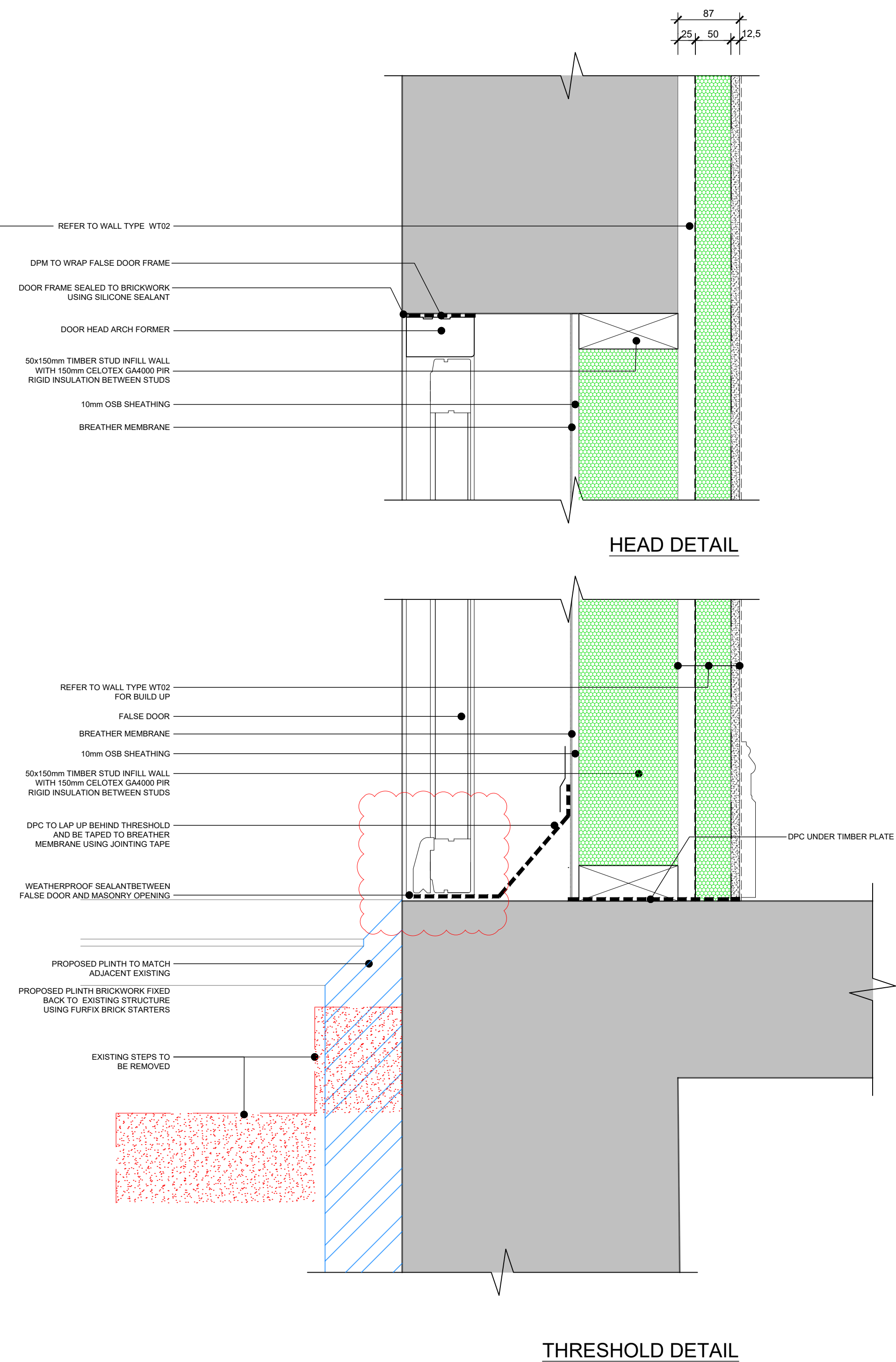
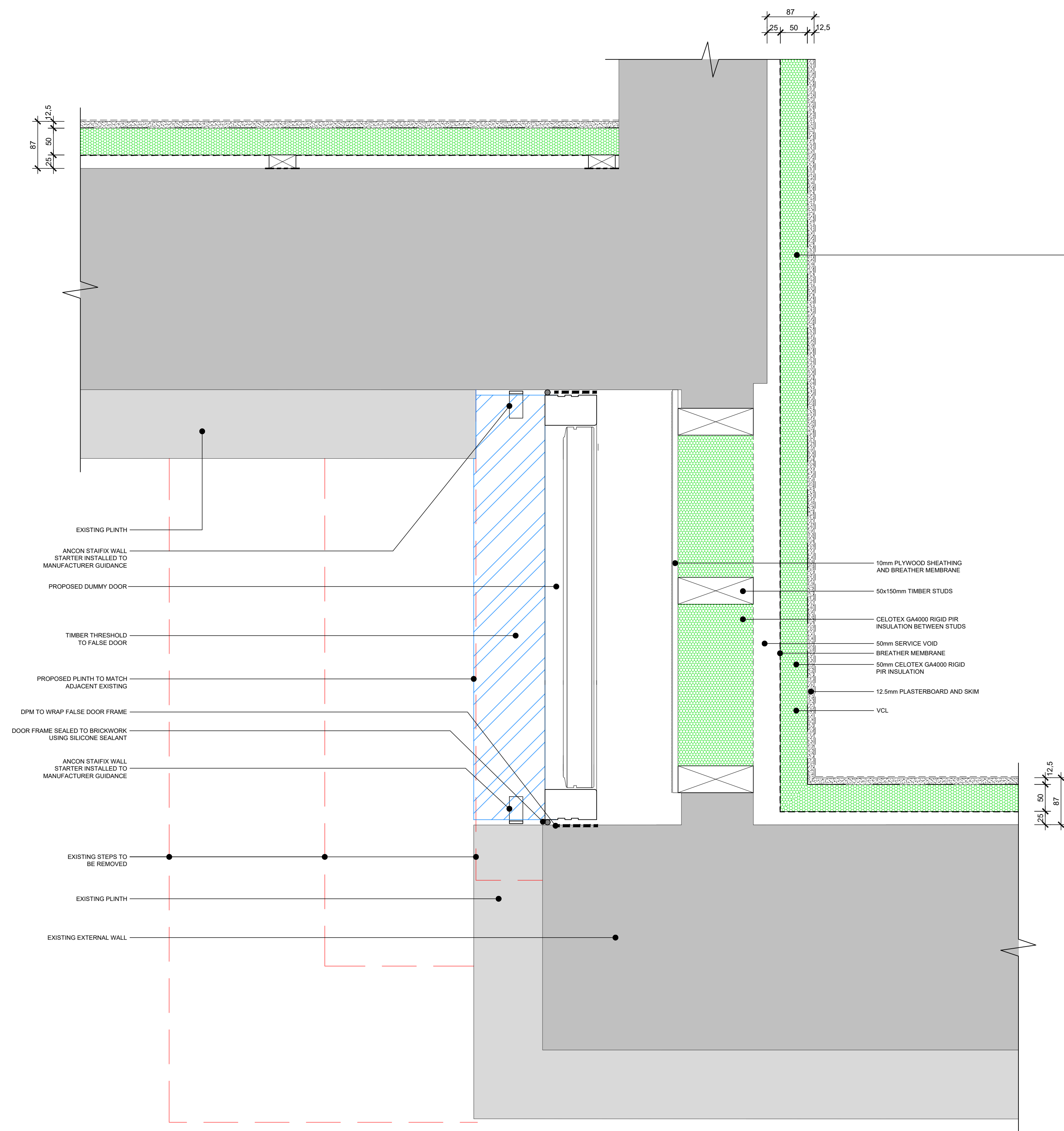

Rev	Date	Detail	Drwn	Chk
C2	10.12.25	THRESHOLD REMOVED.	RS	
C1	29.08.25	CONSTRUCTION ISSUE	RS	CH

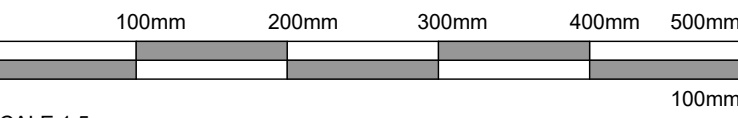

status

 **ASCOT DESIGN**
®Timeless architecture

HEAD OFFICE Austrian Manor, Austurpark Church, Lene, Summinghill, ASLOT, SLS 7DD Tel: 01344 299 330	MANCHESTER No. 1 Booths Park, Chesford Road, Kinsford, W16 8GS Tel: 01615 756 147	LONDON 29 Farm Street, Mayfair, London, W1J 5RL Tel: 020 39940015
---	---	---

Email: info@ascotdesign.com
www.ascotdesign.com

MR STEVE HICKS

Project Title

THE MOAT HOUSE, BIGGS LANE,
ARBORFIELD, WOKINGHAM RG29LN

Drawing Title

EXTERNAL FALSE DOOR G15 DETAILS

Scale 1:5@ A1	Date JUN 2025	Drawn RJS	Rev C2
------------------	------------------	--------------	-----------

Job N°.	Drawing N°.
25-J4803	16-005

The Copyright in this document and design is confidential to
and the property of Ascot Design Limited.

PLAN - REVEAL

EXTERNAL FALSE DOOR G15