

© ABLEY LETCHFORD PARTNERSHIP LTD.
This drawing should not be reproduced without consent.

GENERAL NOTES:

- Do not scale.
- Refer to all other Project Drawings and supporting notes.

Rev	Date	Description	CS	RF
A	06.25	FIRST ISSUE		

Abley Letchford
www.ableyletchford.co.uk

Client
UNIVERSITY OF READING

Project
LODDON GARDEN VILLAGE

Title
TYPICAL FOUL PUMP STATION - GENERAL ARRANGEMENT

Status

Scale	Date	Drawn	Checked
AS SHOWN @ A1	JUN 2025	CS	RF

Drawing No.	Revision
A392-OPA-0540	A

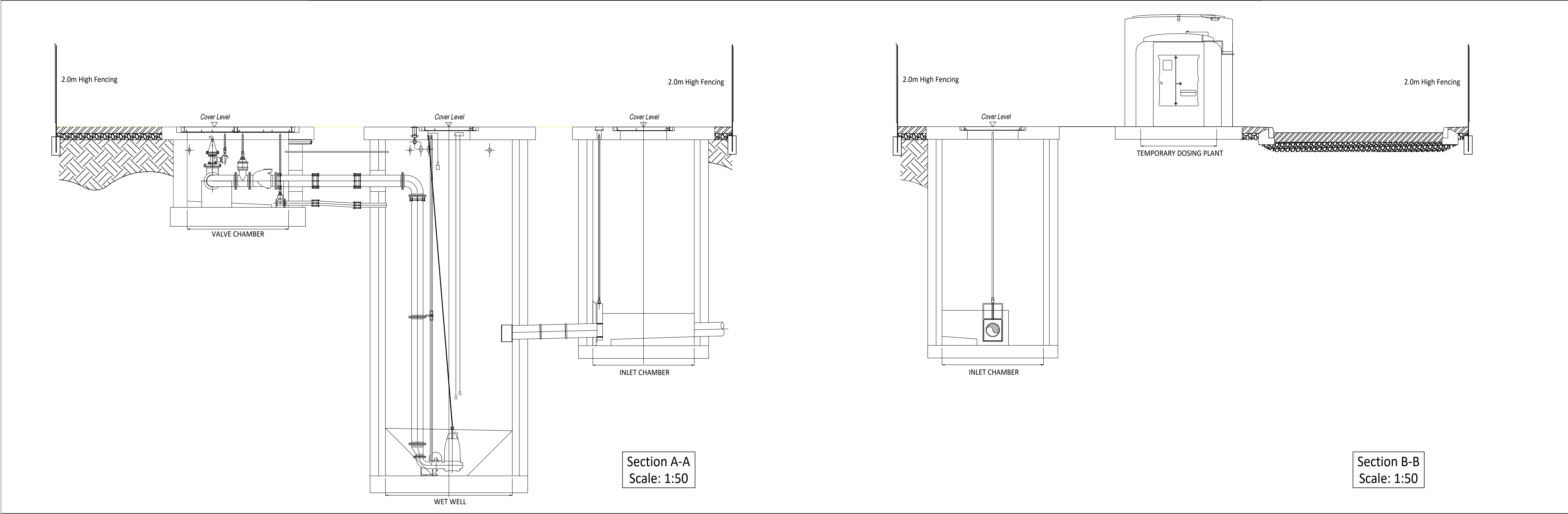

Proposed 125mm Upstand Kerb

Proposed Traffic Island - Tarmacadam

Proposed 125mm Upstand Quadrant Kerb

5m

2m

Not to scale

Pedestrian Refuge Island Kerb Alignment

The main drawing is a detailed highway materials plan for a road junction and its continuation. It shows a central roundabout with a green grassed area in the center. The roads are color-coded: asphalt footways in grey, asphalt shared footways/cycleways in light blue, asphalt shared footways in light orange, and verges in light green. Kerbs are shown in various colors: 125mm upstand kerbs in cyan, 20mm upstand kerbs in magenta, 6mm upstand kerbs in red, 0mm upstand inverted kerbs in blue, and 0mm upstand edging kerbs in yellow. Tree protection areas (RPA and VTB) are marked with dashed magenta and blue lines respectively. Dimensions are provided for various sections of the road and kerbs. Arrows indicate the direction of traffic flow. A north arrow is located in the top right corner.

The key plan shows the project area's location within the local road network. It includes Lower Earley Way, River Loddon, M4, Mole Road, Church Lane, and Reading Road. A red line indicates the redline boundary. A box labeled 'KEY PLAN NTS' is present.

© ABLEY LETCHFORD PARTNERSHIP LTD.
This drawing should not be reproduced without consent.

GENERAL NOTES:
1. Do not scale.
2. Refer to all other Project Drawings and supporting notes.
3. **Transition Kerbs to be installed Between all changes in kerb type.**

KEY:

Uncontrolled Blister Tactile Paving at Dropped Crossing

Controlled Blister Tactile Paving at Signalised Crossing

Segregated Footway / Cycleway Corduroy Tactiles

Proposed Asphalt Shared/ Segregated Footway Cycleway

Proposed Asphalt Shared Footway / Cycleway

Proposed Asphalt Footway

Proposed Verge

Proposed Verge / SuDS Feature

Proposed Asphalt Carriageway

Proposed Mown Path

Proposed Hoggan Path

Proposed Hard Standing

Proposed 125mm Upstand Kerb.
Appropriate Inlet / Orifice for SuDS
Provision to be Introduced Where Necessary.

Proposed 20mm Upstand Kerb

Proposed 6mm Upstand Kerb

Proposed 0mm Upstand Inverted Kerb

Proposed 0mm Upstand Edging Kerb

Arboricultural Survey - Received by FLAC on 15/05/25:
RPA Root Protection Area
VTB Veteran Tree Protection Area

0 5 10 15 20 25m
Scale 1:500

A	06.25	FIRST ISSUE	JJS	CS
Rev	Date	Description	Drawn	Checked

Abley Letchford

www.ableyletchford.co.uk

Client
UNIVERSITY OF READING

Project
LODDON GARDEN VILLAGE

Title
HIGHWAY MATERIALS PLAN
SHEET 1 OF 8

Status

Scale
1:500 @ A1

Date
JUNE 2025

Drawn
JJS

Checked
CS

Drawing No
A392-OPA-0701

Revision
A



© ABLEY LETCHFORD PARTNERSHIP LTD.
This drawing should not be reproduced without consent.

GENERAL NOTES:

- Do not scale.
- Refer to all other Project Drawings and supporting notes.
- Transition Kerbs to be installed Between all changes in kerb type.

KEY:

- Uncontrolled Blister Tactile Paving at Dropped Crossing
- Controlled Blister Tactile Paving at Signalised Crossing
- Segregated Footway / Cycleway Corduroy Tactiles
- Proposed Asphalt Shared/ Segregated Footway Cycleway
- Proposed Asphalt Shared Footway / Cycleway
- Proposed Asphalt Footway
- Proposed Verge
- Proposed Verge / SuDS Feature
- Proposed Asphalt Carriageway
- Proposed Mown Path
- Proposed Hoggin Path
- Proposed Hard Standing
- Proposed 125mm Upstand Kerb. Appropriate Inlet / Orifice for SuDS Provision to be Introduced Where Necessary.
- Proposed 20mm Upstand Kerb
- Proposed 6mm Upstand Kerb
- Proposed 0mm Upstand Inverted Kerb
- Proposed 0mm Upstand Edging Kerb

Arboricultural Survey - Received by FLAC on 15/05/25:

- RPA Root Protection Area
- VTB Veteran Tree Protection Area

0 5 10 15 20 25m
Scale 1:500

A	06.25	FIRST ISSUE	JJS	CS
Rev	Date	Description	Drawn	Checked

www.ableyletchford.co.uk

Client

UNIVERSITY OF READING

Project

LODDON GARDEN VILLAGE

Title

HIGHWAY MATERIALS PLAN
SHEET 2 OF 8

Status

Scale	Date	Drawn	Checked
1:500 @ A1	JUNE 2025	JJS	CS

Drawing No: A392-OPA-0702

Revision

A



© ABLEY LETCHFORD PARTNERSHIP LTD.
This drawing should not be reproduced without consent.

GENERAL NOTES:

- Do not scale.
- Refer to all other Project Drawings and supporting notes.
- Transition Kerbs to be installed Between all changes in kerb type.**

KEY:

- Uncontrolled Blister Tactile Paving at Dropped Crossing
- Controlled Blister Tactile Paving at Signalised Crossing
- Segregated Footway / Cycleway Corduroy Tactiles
- Proposed Asphalt Shared / Segregated Footway Cycleway
- Proposed Asphalt Shared Footway / Cycleway
- Proposed Asphalt Footway
- Proposed Verge
- Proposed Verge / SuDS Feature
- Proposed Asphalt Carriageway
- Proposed Mown Path
- Proposed Hoggin Path
- Proposed Hard Standing
- Proposed 125mm Uprand Kerb. Appropriate Inlet / Orifice for SuDS Provision to be Introduced Where Necessary.
- Proposed 20mm Uprand Kerb
- Proposed 6mm Uprand Kerb
- Proposed 0mm Uprand Inverted Kerb
- Proposed 0mm Uprand Edging Kerb

Arboricultural Survey - Received by FLAC on 15/05/25:

- RPA Root Protection Area
- VTB Veteran Tree Protection Area

0 5 10 15 20 25m
Scale 1:500

A	06.25	FIRST ISSUE	JJS	CS
Rev	Date	Description	Drawn	Checked

www.ableyletchford.co.uk

Client

UNIVERSITY OF READING

Project

LODDON GARDEN VILLAGE

Title

HIGHWAY MATERIALS PLAN
SHEET 3 OF 8

Status

Scale	Date	Drawn	Checked
1:500 @ A1	JUNE 2025	JJS	CS

Drawing No	Revision
A392-OPA-0703	A

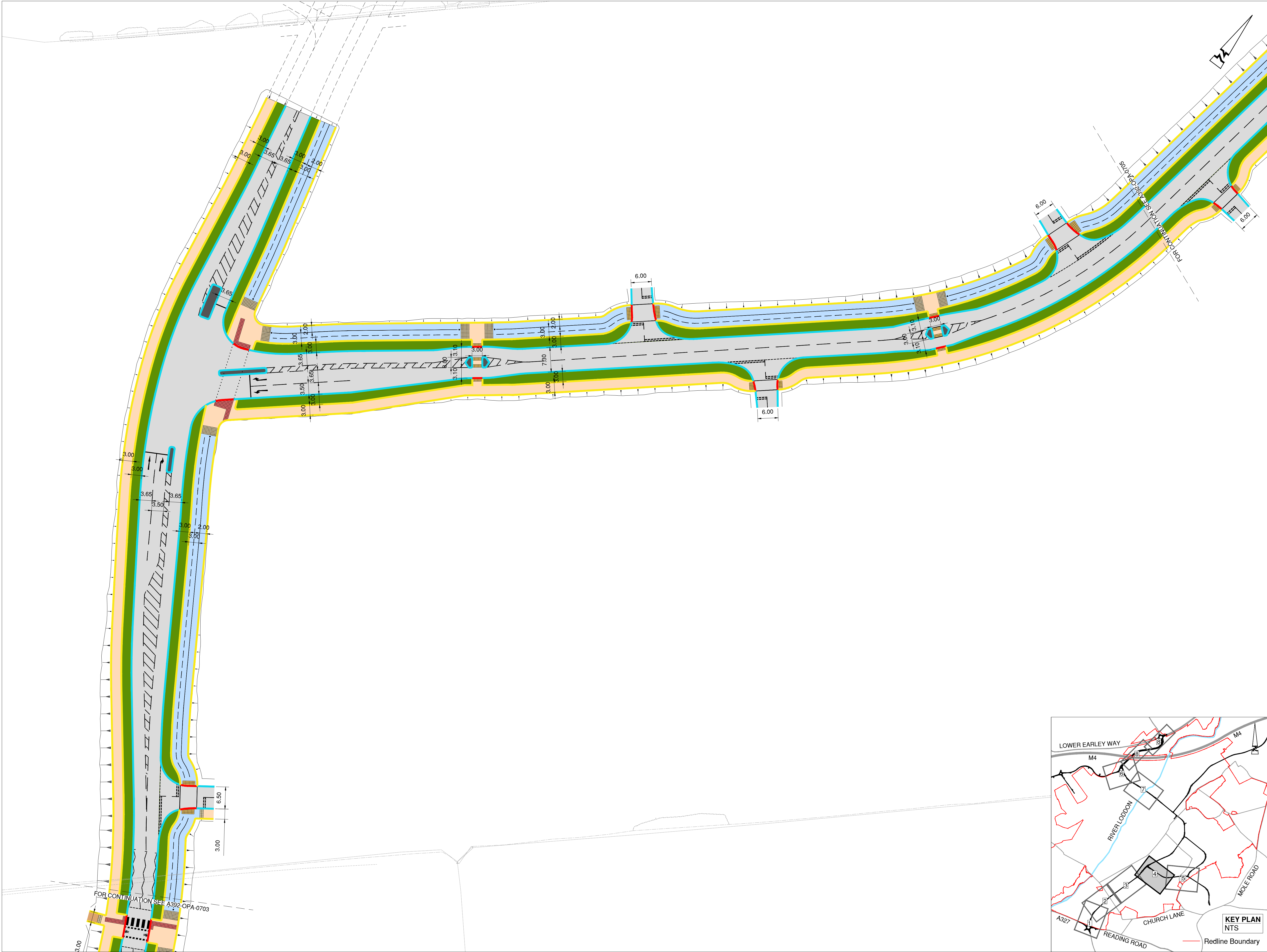

© ABLEY LETCHFORD PARTNERSHIP LTD.
This drawing should not be reproduced without consent.

GENERAL NOTES:

- Do not scale.
- Refer to all other Project Drawings and supporting notes.
- Transition Kerbs to be installed Between all changes in kerb type.**

KEY:

- Uncontrolled Blister Tactile Paving at Dropped Crossing
- Controlled Blister Tactile Paving at Signalised Crossing
- Segregated Footway / Cycleway Corduroy Tactiles
- Proposed Asphalt Shared/ Segregated Footway Cycleway
- Proposed Asphalt Shared Footway / Cycleway
- Proposed Asphalt Footway
- Proposed Verge
- Proposed Verge / SuDS Feature
- Proposed Asphalt Carriageway
- Proposed Mown Path
- Proposed Hoggin Path
- Proposed Hard Standing
- Proposed 125mm Uprand Kerb. Appropriate Inlet / Orifice for SuDS Provision to be Introduced Where Necessary.
- Proposed 20mm Uprand Kerb
- Proposed 6mm Uprand Kerb
- Proposed 0mm Uprand Inverted Kerb
- Proposed 0mm Uprand Edging Kerb

Arboricultural Survey - Received by FLAC on 15/05/25:

- RPA Root Protection Area
- VTB Veteran Tree Protection Area

0 5 10 15 20 25m
Scale 1:500

Rev	Date	Description	Drawn	Checked
A	06.25	FIRST ISSUE	JJS	CS

www.ableyletchford.co.uk

Client

UNIVERSITY OF READING

Project

LODDON GARDEN VILLAGE

Title

HIGHWAY MATERIALS PLAN
SHEET 4 OF 8

Status

Scale	Date	Drawn	Checked
1:500 @ A1	JUNE 2025	JJS	CS

Drawing No	Revision
A392-OPP-0704	A

KEY PLAN
NTS

Redline Boundary

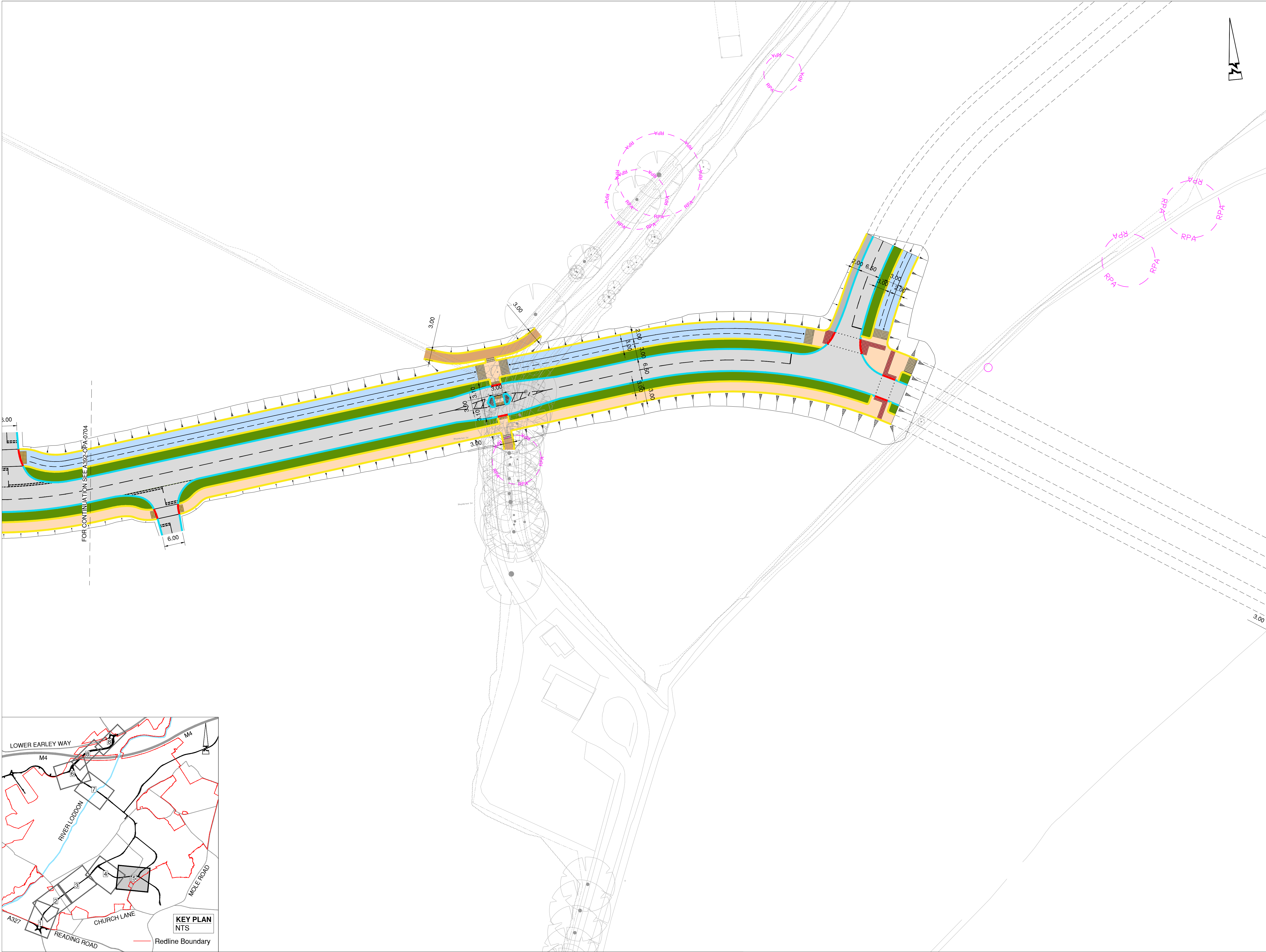

© ABLEY LETCHFORD PARTNERSHIP LTD.
This drawing should not be reproduced without consent.

GENERAL NOTES:

- Do not scale.
- Refer to all other Project Drawings and supporting notes.
- Transition Kerbs to be installed Between all changes in kerb type.**

KEY:

- Uncontrolled Blister Tactile Paving at Dropped Crossing
- Controlled Blister Tactile Paving at Signalised Crossing
- Segregated Footway / Cycleway Corduroy Tactiles
- Proposed Asphalt Shared/ Segregated Footway Cycleway
- Proposed Asphalt Shared Footway / Cycleway
- Proposed Asphalt Footway
- Proposed Verge
- Proposed Verge / SuDS Feature
- Proposed Asphalt Carriageway
- Proposed Mown Path
- Proposed Hoggin Path
- Proposed Hard Standing
- Proposed 125mm Upstand Kerb. Appropriate Inlet / Orifice for SuDS Provision to be Introduced Where Necessary.
- Proposed 20mm Upstand Kerb
- Proposed 6mm Upstand Kerb
- Proposed 0mm Upstand Inverted Kerb
- Proposed 0mm Upstand Edging Kerb

Arboricultural Survey - Received by FLAC on 15/05/25:

- RPA Root Protection Area
- VTB Veteran Tree Protection Area

0 5 10 15 20 25m
Scale 1:500

A	06.25	FIRST ISSUE	JJS	CS
Rev	Date	Description	Drawn	Checked

www.ableyletchford.co.uk

Client

UNIVERSITY OF READING

Project

LODDON GARDEN VILLAGE

Title

HIGHWAY MATERIALS PLAN
SHEET 5 OF 8

Status

Scale	Date	Drawn	Checked
1:500 @ A1	JUNE 2025	JJS	CS

Drawing No	Revision
A392-OPA-0705	A



© ABLEY LETCHFORD PARTNERSHIP LTD.
This drawing should not be reproduced without consent.

GENERAL NOTES:

- Do not scale.
- Refer to all other Project Drawings and supporting notes.
- Transition Kerbs to be installed Between all changes in kerb type.

KEY:

- Uncontrolled Blister Tactile Paving at Dropped Crossing
- Controlled Blister Tactile Paving at Signalised Crossing
- Segregated Footway / Cycleway Corduroy Tactiles
- Proposed Asphalt Shared/ Segregated Footway Cycleway
- Proposed Asphalt Shared Footway / Cycleway
- Proposed Asphalt Footway
- Proposed Verge
- Proposed Verge / SuDS Feature
- Proposed Asphalt Carriageway
- Proposed Mown Path
- Proposed Hoggin Path
- Proposed Hard Standing
- Proposed 125mm Upstand Kerb. Appropriate Inlet / Orifice for SuDS Provision to be Introduced Where Necessary.
- Proposed 20mm Upstand Kerb
- Proposed 6mm Upstand Kerb
- Proposed 0mm Upstand Inverted Kerb
- Proposed 0mm Upstand Edging Kerb

Arboricultural Survey - Received by FLAC on 15/05/25:

- RPA Root Protection Area
- VTB Veteran Tree Protection Area

0 5 10 15 20 25m
Scale 1:500

A	06.25	FIRST ISSUE	JJS	CS
Rev	Date	Description	Drawn	Checked

www.ableyletchford.co.uk

Client

UNIVERSITY OF READING

Project

LODDON GARDEN VILLAGE

Title

HIGHWAY MATERIALS PLAN
SHEET 6 OF 8

Status

Scale	Date	Drawn	Checked
1:500 @ A1	JUNE 2025	JJS	CS

Drawing No

A392-OPA-0706

Revision

A

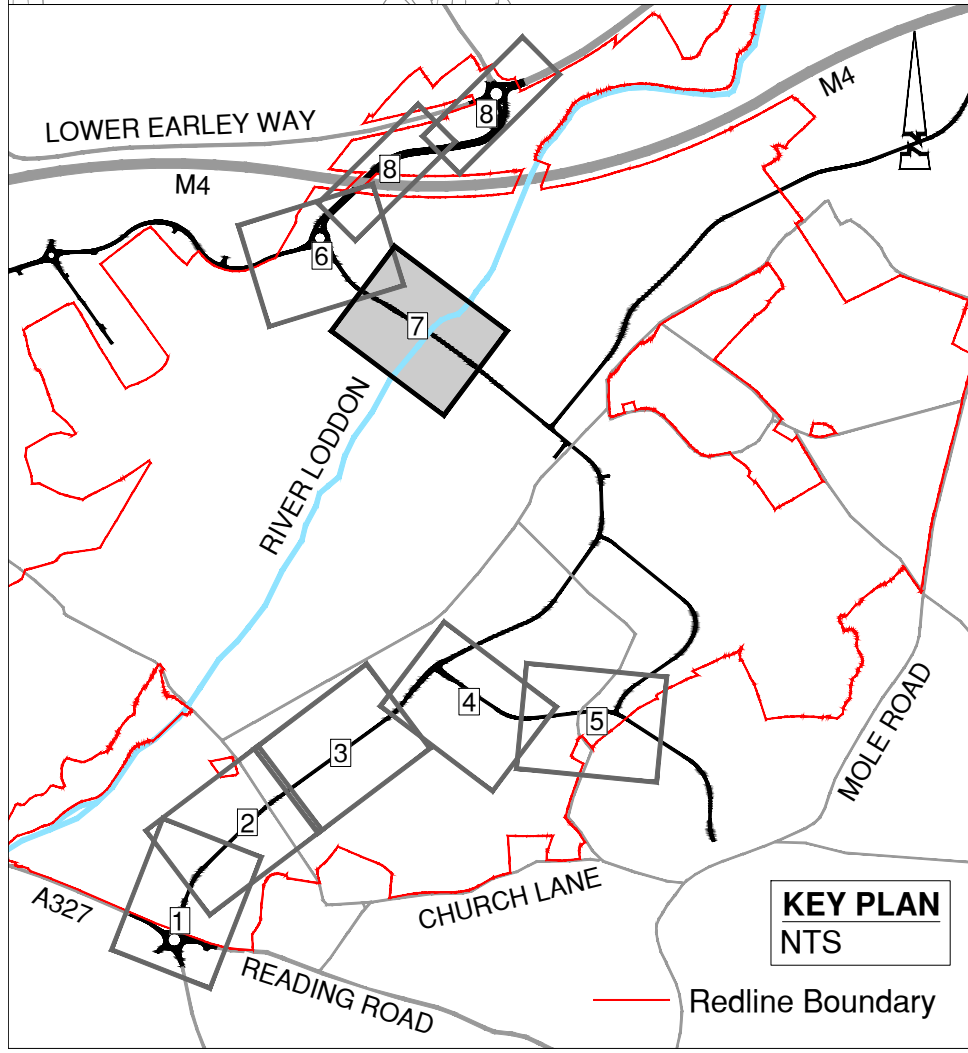
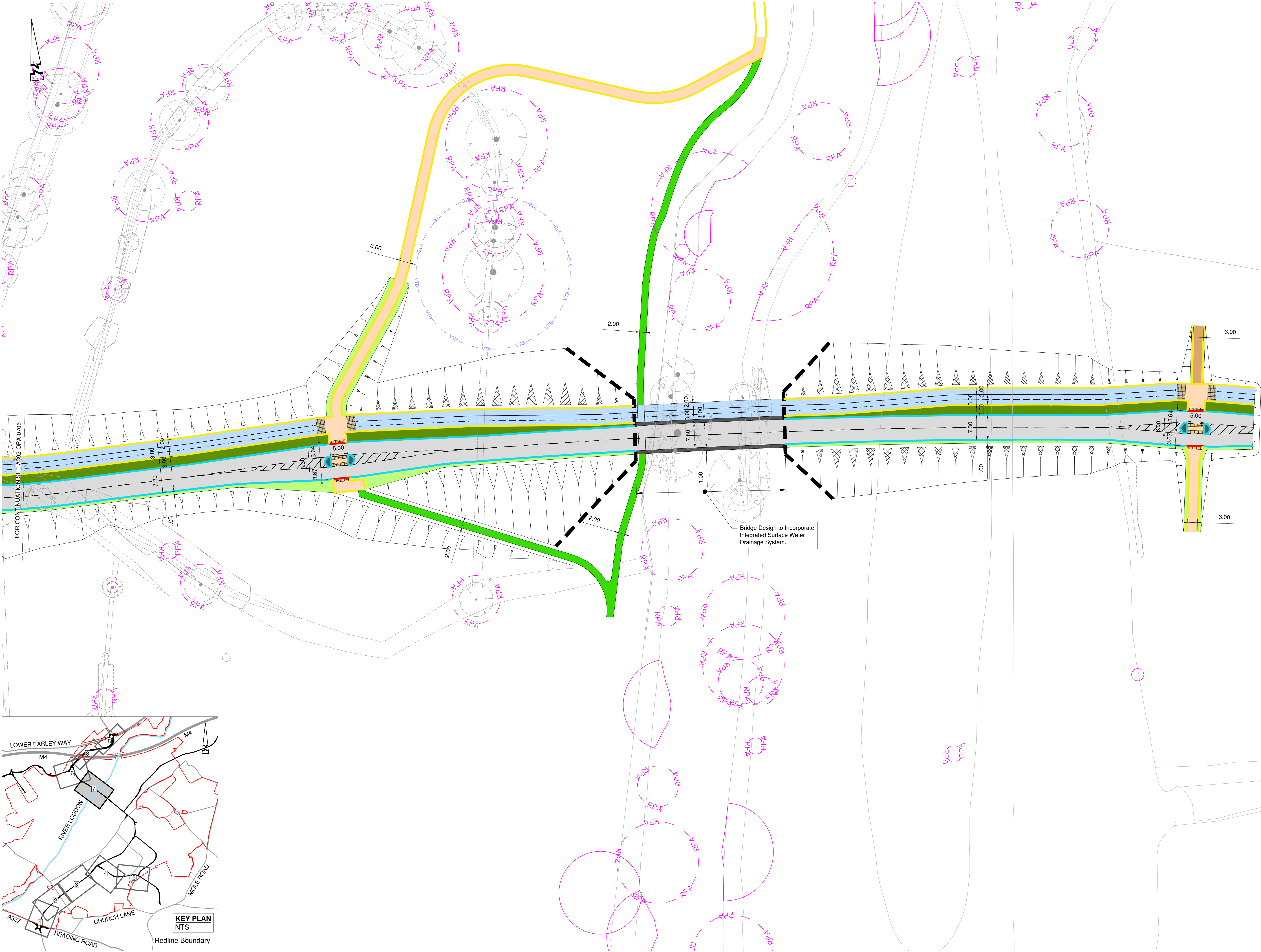

© ABLEY LETCHFORD PARTNERSHIP LTD.
This drawing should not be reproduced without consent.

GENERAL NOTES:

- Do not scale.
- Refer to all other Project Drawings and supporting notes.
- Transition Kerbs to be installed Between all changes in kerb type.

KEY:

- Uncontrolled Blister Tactile Paving at Dropped Crossing
- Controlled Blister Tactile Paving at Signalised Crossing
- Segregated Footway / Cycleway Corduroy Tactiles
- Proposed Asphalt Shared/ Segregated Footway Cycleway
- Proposed Asphalt Shared Footway / Cycleway
- Proposed Asphalt Footway
- Proposed Verge
- Proposed Verge / SuDS Feature
- Proposed Asphalt Carriageway
- Proposed Mown Path
- Proposed Hoggin Path
- Proposed Hard Standing
- Proposed 125mm Uprand Kerb. Appropriate Inlet / Orifice for SuDS Provision to be Introduced Where Necessary.
- Proposed 20mm Uprand Kerb
- Proposed 6mm Uprand Kerb
- Proposed 0mm Uprand Inverted Kerb
- Proposed 0mm Uprand Edging Kerb

Arboricultural Survey - Received by FLAC on 15/05/25:

- RPA Root Protection Area
- VTB Veteran Tree Protection Area

0 5 10 15 20 25m
Scale 1:500

Rev	Date	Description	Drawn	Checked
A	06.25	FIRST ISSUE	JJS	CS

Client
UNIVERSITY OF READING

Project
LODDON GARDEN VILLAGE

Title
HIGHWAY MATERIALS PLAN
SHEET 7 OF 8

Status

Scale	Date	Drawn	Checked
1:500 @ A1	JUNE 2025	JJS	CS

Drawing No
A392-OPA-0707

Revision
A