

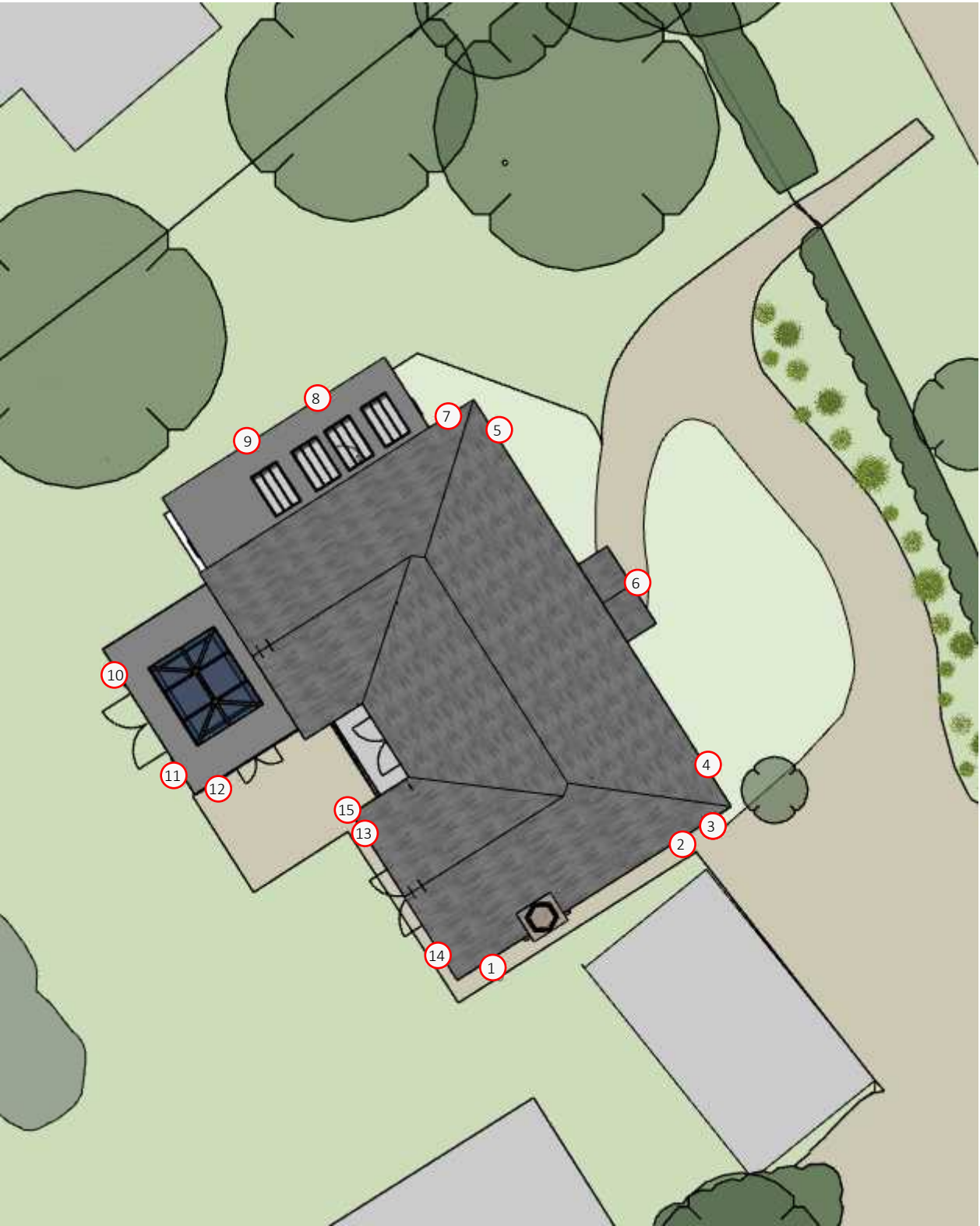

LIGHTING PLAN KEY



LIGHTING PLAN
Existing
Scale 1:200

Ordnance Survey, ©Crown Copyright 2021. All rights reserved. Licence number 100019980

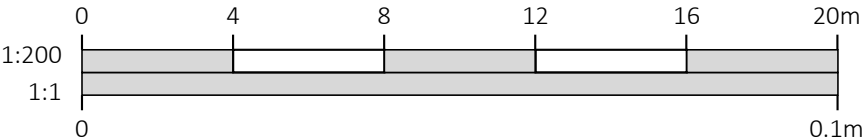

A	Amended Plans	26.01.26	JL
-	Preliminary issue	20.11.25	JL

DRAWINGS PRODUCED BY

T.J. Crump Oakwrights Ltd
The Lakes, Swainshill,
Hereford, HR4 7PU

+44 (0)1432 35353
enquiries@oakwrights.co.uk

© This drawing, its contents, and all information contained therein is protected by Copyright. It may be used once only for its intended purpose under a contract with T.J. Crump Oakwrights Ltd, but not for any other use or purpose. This drawing is for Planning purposes and does not constitute a construction issue drawing. All setting out dimensions and levels are indicative and are subject to detailed site survey and site conditions. The Client and their agent are responsible for ensuring that Building Control and construction drawings are carried out following Planning approval. Scaling from this drawing is for Local Planning Authority information only.

CLIENT

Mr And Mrs Hart

SITE ADDRESS

Hatchgate End,
Hatchgate Lane,
RG10 8NE

PROJECT

Proposed Dwelling

DEPARTMENT

ARCHITECTURE

DRAWING

PROPOSED LIGHTING PLAN

SCALE

1:200 @A3

DATE DRAWN	DATE ISSUED
20.11.25	26.01.26

DRAWN	CHECKED
JAC/JL	

ISSUE STATUS

PLANNING

DRG. NO.	REV.
2748.1.2- HAR-20	A