

To be read in conjunction with landscape
architect's drawings & C1498 100 Location Plan.

Key

- Site Boundary
- Overall DWH Masterplan Boundary

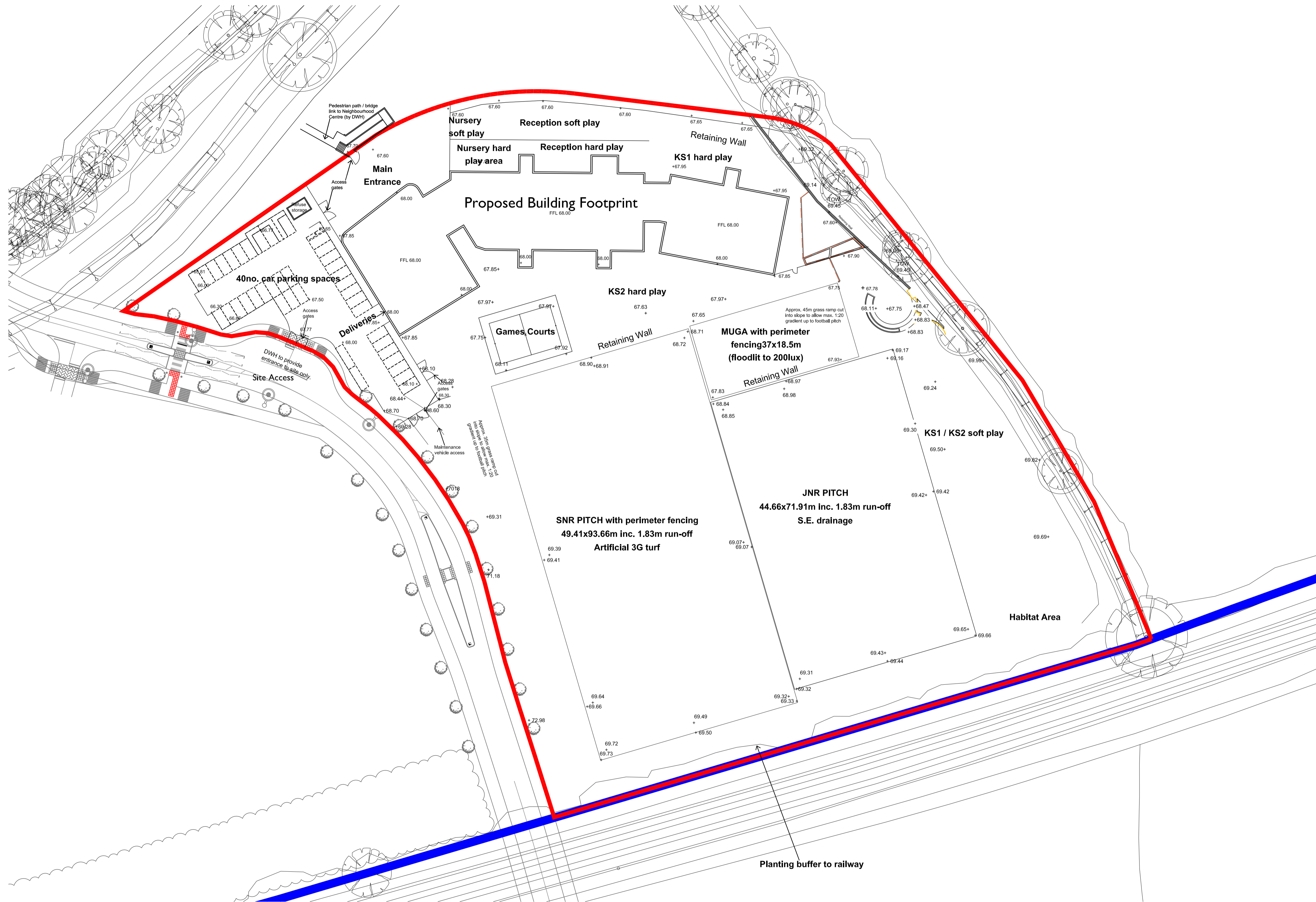

Rev B	Ramp and path to neighbourhood centre shown.	29.04.14 NH
Rev A	Planning issue	27.02.14 AS
		REVISIONS

PLANNING ISSUE



Proposed Site Plan

27 SPON STREET, COVENTRY, CV1 3BATEL:- (024) 76527 600 FAX:- (024) 76520 424 E-mail:- info@idpmidlands.com Web:- www.idpmidlands.com



Interserve Construction Limited
Bridgers Farm, Nursling Street
Nursling, Southampton,
Hampshire, SO16 0YA
Tel: 023 8074 8282

SCALE @ A1	1:500
DATE	Oct. 2013
DRAWN	NH
CHECKED	JH

CLIENT	David Wilson Homes
JOB TITLE	Montague Primary School
DRAWING TITLE	Proposed Site Plan
DRAWING NO.	C1498 / 102 B